

MAIN GUARD™

94WM Sampling Station

Below-Grade Dedicated Bac-T Sampling Station

- *Installs in 5/8" x 3/4" meter pits (1" size also available)*
- *Brass and stainless waterway*
- *Sampling rod (and case) sold separately*
- *Spring-loaded valve activated when sampling rod is attached (unique thread pattern)*
- *Threaded sampling rod eliminates the stress seen with quick-disconnect models*
- *Rod includes a swivel blow-off head and separate sampling point*
- *NSF/ANSI 372 Certified*

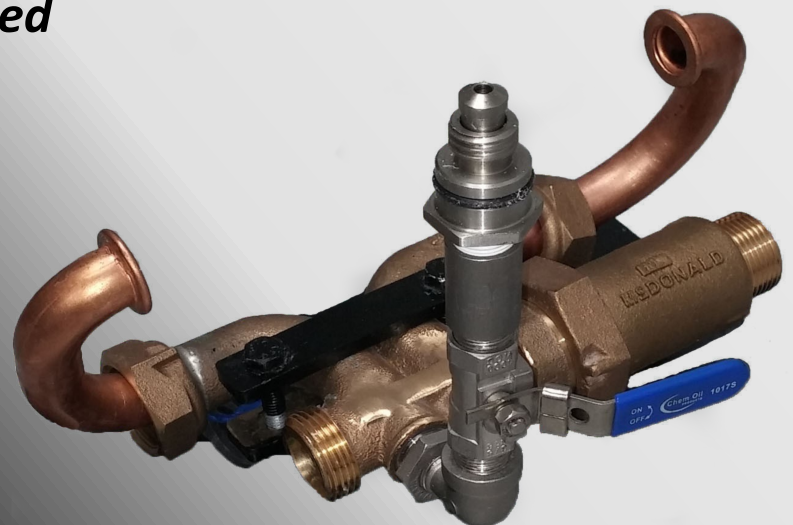

#94WM-FXT METER (5/8" x 3/4") RESETTER SAMPLING STATION SPEC SHEET

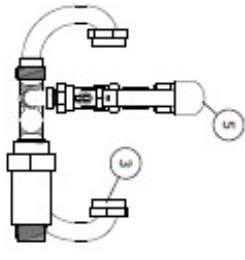

A FRONT VIEW
Scale: 1 1/2"=1'-0"

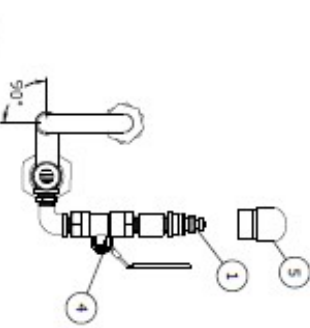

B SIDE HORN ANGLE VIEW
Scale: 1 1/2"=1'-0"

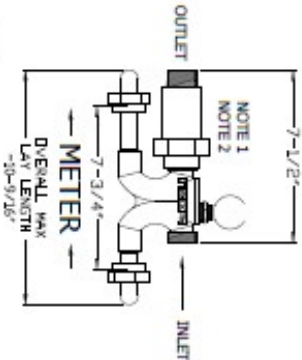

C WATER FLOW VIEW
Scale: 1 1/2"=1'-0"



D ISOMETRIC VIEW
Scale: 1 1/2"=1'-0"



E LAY LENGTH OPTIONS
Scale: 1 1/2"=1'-0"

#94WM-FXT Meter (5/8" x 3/4") Resetter Sampling Station Spec Sheet shall be installed in the following location(s):

Meter Resetter Sampling Station shall be meter box retrofit style for a 5/8" x 3/4" meter, with 1" NPS threaded inlet and outlet, both with a face for gasket seal. If desired the dual check valve (brass body) can be replaced with an idler/spacer option to be located between the water meter and residence.

The angle between the horns and body are fixed at 90 deg, with other angles available upon request. Kupferle also offers #95WM which features a PVC body with horns that can rotate 180 to accommodate different angles as needed.

To perform sampling, a portable rod (Kupferle Part # Z94PR) with a female coupler will thread onto the S, S, male spring loaded piston valve (#1) connected to the meter setter. This connection shall require a turning motion only, with no pushing or pulling necessary. Male valve shall be located before the water meter, have an auxiliary shut-off valve, and be protected by a PVC cover when not in use.

Unit model # shall be 94WM-FXT-S-BD as specified in the product ordering guide as manufactured by Kupferle Foundry Company, St. Louis MO, or approved equal.

ITEM	DESCRIPTION
1	S.S. MALE SPRING LOADED SAMPLING VALVE
2	SAWM BODY (5/8" x 1/2")
3	3/4" BSPW RUBBER METRE GASKET
4	3/4" TOP LOCKABLE BALL VALVE
5	PVC COVER WITH CAP

RESETTER PRODUCT ORDERING GUIDE			
MODEL #	SAWM	PIST	SPR
SUBSECTION	1	2	3
1	2	3	4
5	6	7	8
9	10	11	12
13	14	15	16
17	18	19	20
21	22	23	24
25	26	27	28
29	30	31	32
33	34	35	36
37	38	39	40
41	42	43	44
45	46	47	48
49	50	51	52
53	54	55	56
57	58	59	60
61	62	63	64
65	66	67	68
69	70	71	72
73	74	75	76
77	78	79	80
81	82	83	84
85	86	87	88
89	90	91	92
93	94	95	96
97	98	99	100

- NOTES:
- 1) THE DUAL CHECK VALVE:
 - A. X. McDONALD (BRASS) DUAL CHECK MANUFACTURED IN COMPLIANCE WITH ANS/AASSE 1024 AND COMPLIANT WITH USA PUBLIC LAW 111-380 AND IDENTIFIED WITH "NL".
 - B. TILER OPTIONAL WITH DIFFERENT BODY STYLES AVAILABLE (PVC OR BRASS).
 - 2) KUPFERLE (PVC) IDLER
 - 3) KUPFERLE (BRASS) IDLER COMPLIANT WITH USA PUBLIC LAW 111-380 AND IDENTIFIED WITH "NL".

10/13/20	ISSUED FOR REFERENCE	MAXIMUM WORKING WATER PRESSURE: 175 PSI
DATE	STATUS / REVISION	TEMPERATURE RANGE: 32 TO 140°F

#94WM-FXT (5/8" x 3/4") RESETTER SAMPLING STATION	INITIALS	DATE
	DECL	10/13/20
	APPROVED	10/30/20
	MODIFIED	
	SHEET SIZE	SCALE
	A (11x8.5)	1-1/2"=1'

KUPFERLE
SINCE 1857

2511 NORTH 9TH STREET
ST. LOUIS, MO 63102
1-800-231-3990
FAX 314-231-2820
www.hydrants.com

#94WM-FxH METER (5/8" x 1/2") RESETTER SAMPLING STATION SPEC SHEET

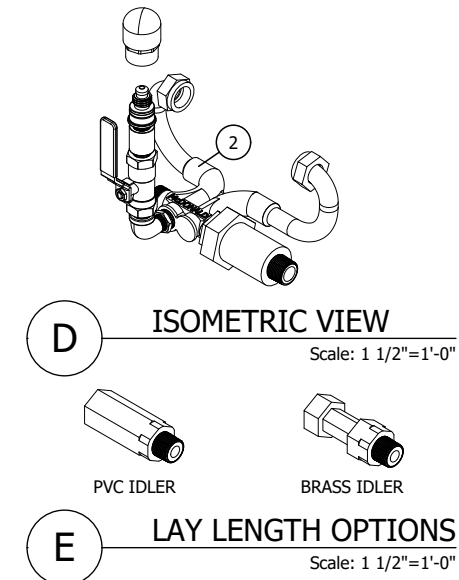
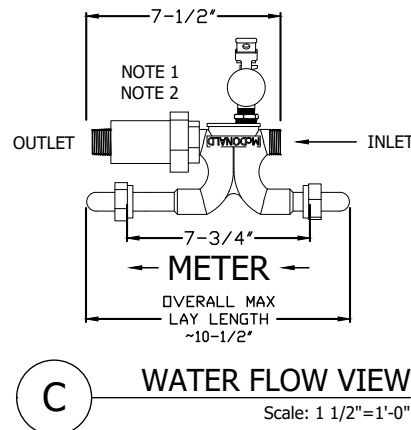
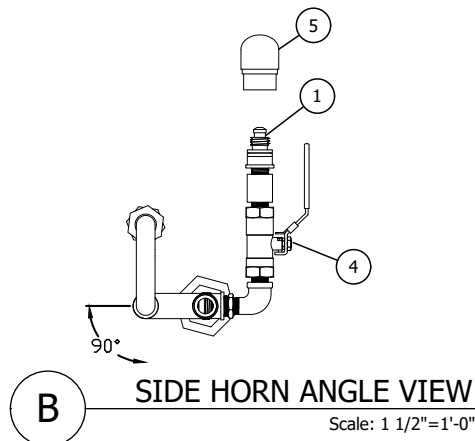
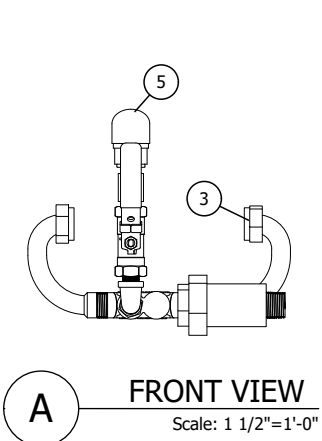

#94WM-FxH Meter (5/8" x 1/2") Resetter Sampling Station Spec Sheet shall be installed in the following location(s):

Meter Resetter Sampling Station shall be meter box retrofit style for a 5/8" x 1/2" meter, with 3/4" NPS threaded inlet and outlet, both with a face for gasket seal. If desired the dual check valve (brass body) can be replaced with an idler/spacer option to be located between the water meter and residence.

The angle between the horns and body are fixed at 90 deg, with other angles available upon request. Kupferle also offers #95WM which features a PVC body with horns that can rotate 180 to accommodate different angles as needed.

To perform sampling, a portable rod (Kupferle Part # Z94PR) with a female coupler will thread onto the S.S. male spring loaded piston valve (#1) connected to the meter setter. This connection shall require a turning motion only, with no pushing or pulling necessary. Male valve shall be located before the water meter, have an auxiliary shut-off valve, and be protected by a PVC cover when not in use.

Unit model # shall be 94WM-FxH-S-BD as specified in the product ordering guide as manufactured by Kupferle Foundry Company, St. Louis MO, or approved equal.

ITEM	DESCRIPTION
1	S.S. MALE SPRING LOADED SAMPLING VALVE
2	94WM BODY (5/8" x 1/2")
3	1/2" EPDM RUBBER METER GASKET
4	3/8" LOCKABLE BALL VALVE
5	PVC COVER WITH CAP

RESETTER PRODUCT ORDERING GUIDE									
MODEL#	94WM	-	FxH	-	S	-	BD		
SUBSECTION	1		2		3		4		
SUBSECTION DESCRIPTION	MODEL #	SUBSECTION	OPTIONS	DESCRIPTIONS					
MODEL		1	94WM	BRASS RESETTER					
SIZE		2	ONE	1" METER					
			FxT	5/8" x 3/4" METER					
SAMPLING OPTIONS		3	FxH	5/8" x 1/2" METER					
			S	STANDARD SAMPLING ASSEMBLY					
LAY LENGTH OPTIONS		4	N	NONE (RESETTER CONFIGURATION)					
			N	NONE					
			BD	BRASS DUAL CHECK VALVE (INLINE)					
			BI	BRASS IDLER					
			PI	PVC IDLER					

- NOTES:
- THE DUAL CHECK VALVE:
 - A.Y. MCDONALD (BRASS) DUAL CHECK MANUFACTURED IN COMPLIANCE WITH ANSI/ASSE 1024 AND COMPLIANT WITH USA PUBLIC LAW 111-380 AND IDENTIFIED WITH "NL".
 - IDLER OPTIONAL WITH DIFFERENT BODY STYLES AVAILABLE (PVC OR BRASS):
 - KUPFERLE (PVC) IDLER
 - A.Y. MCDONALD (BRASS) IDLER COMPLIANT WITH USA PUBLIC LAW 111-380 AND IDENTIFIED WITH "NL".

10/13/20	ISSUED FOR REFERENCE	MAXIMUM WORKING WATER PRESSURE: 175 PSI TEMPERATURE RANGE: 32° TO 140°F
DATE	STATUS / REVISION	

	INITIALS	DATE
DRAWN	DCL	10/13/20
APPROVED	DCL	10/30/20
MODIFIED		
	SHEET SIZE	SCALE
	A (11x8.5)	1-1/2"=1'

#94WM-FxH (5/8" x 1/2") RESETTER SAMPLING STATION

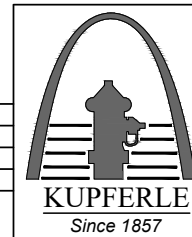

2511 NORTH 9TH STREET
ST. LOUIS, MO 63102
1-800-231-3990
FAX 314-231-2820
www.hydrants.com

#94-WM CUT SHEET

(5/8" x 1/2" RESETTER)

PARTS LIST

ITEM	QTY	PART NUMBER	DESCRIPTION	NOTES
1	1	1/2 x 3/8HBSS	1/2" x 3/8" S.S. HEX BUSHING	
2	1	3/890SLSS	3/8" S.S. STREET ELBOW	
3	2	3/8CNSS	3/8" S.S. CLOSE NIPPLE	
4	1	3/8SBV	3/8" S.S. BALL VALVE	C
5	1	3/8SSC	3/8" S.S. COUPLING	
6	1	88-12	PLUNGER O-RING	
7	2	92-C	RETAINING E-CLIP	
8	1	92-O	SAMPLING VALVE TOP O-RING	
9	1	92-OO	PLUNGER TIP O-RING	
10	1	92-P	SAMPLING VALVE PLUNGER PISTON	
11	1	92-S	SPRING	
12	1	92-V	SAMPLING VALVE BODY	
13	1	94-A	3/4" SCH. 40 PVC CAP	
14	1	94-D-3	BRASS DUAL CHECK VALVE	C
15	1	94-E	3/4" SCH. 40 PVC ADAPTER	
16	1	94-R-3	METER RESETTER (5/8" x 1/2")	C
OPTIONAL/REPAIR PARTS LIST				
17	0	94-I-2	BRASS IDLER (5/8" x 1/2")	C
18	0	95WM-I-2	PVC IDLER (5/8" x 1/2")	C

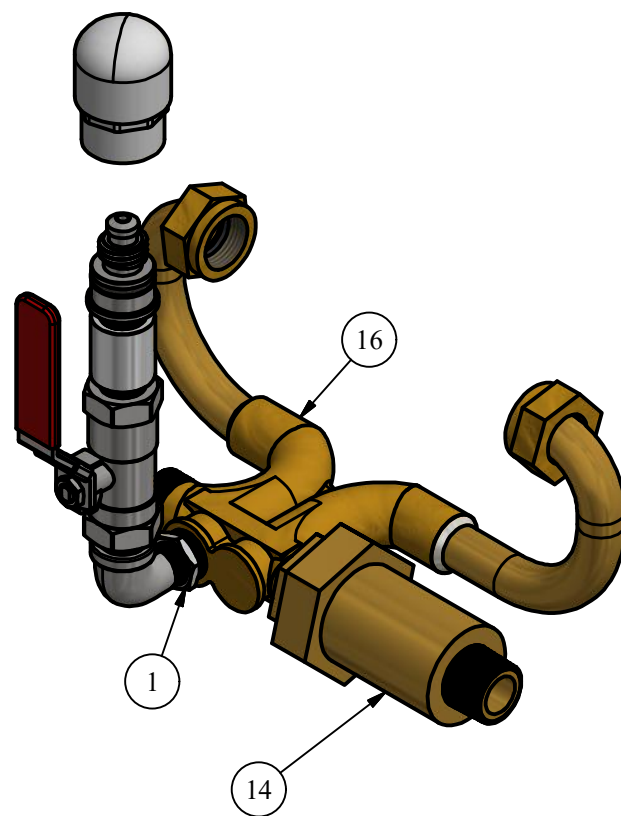
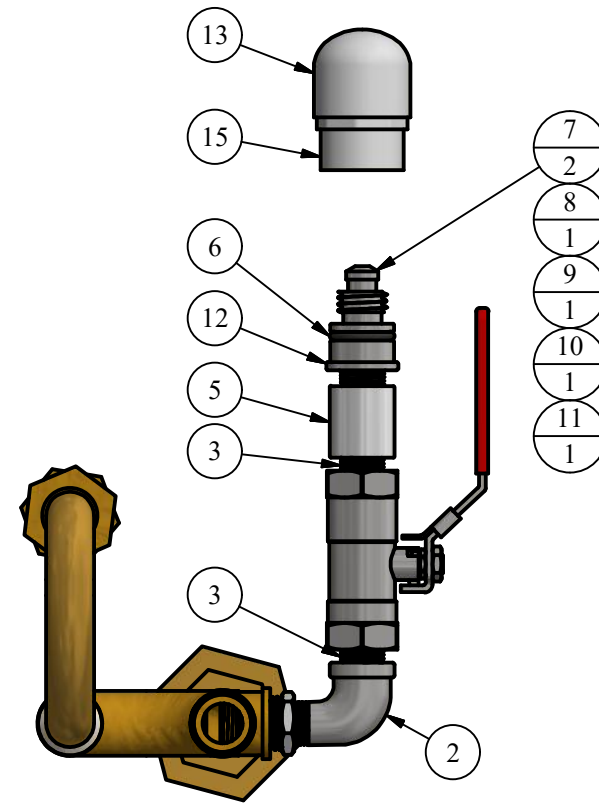

Z94PR ASSEMBLY (NOTE T)

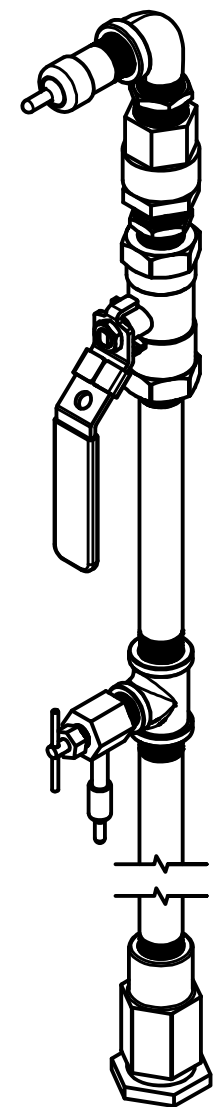

OPTIONAL 95WM-I-2 PVC IDLER

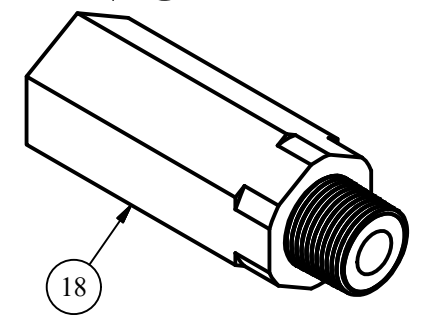

OPTIONAL 94-I-2 BRASS IDLER

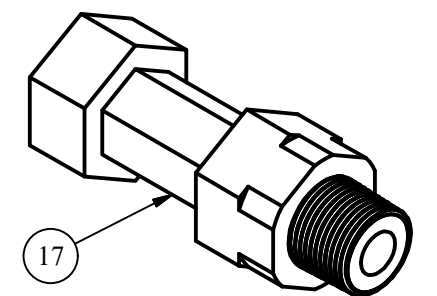

X94WM-ASSY ASSEMBLY

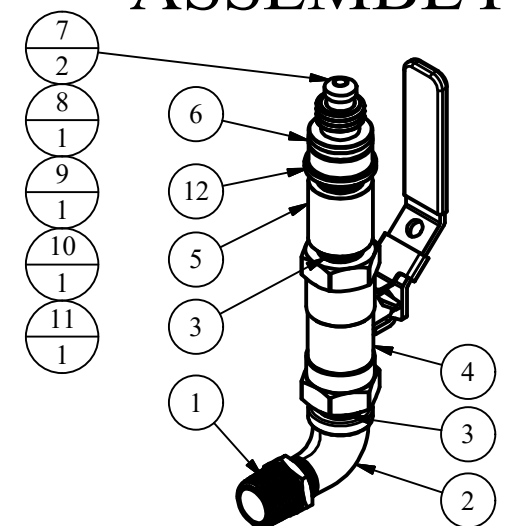

REPAIR KITS

PART NUMBER	DESCRIPTION	PARTS INCLUDED
X94WM-ASSY	94WM SAMPLING ASSEMBLY	1/2 X 3/8HBSS BUSHING (1), 3/890SLSS ELBOW (1), 3/8SSCN CLOSE NIPPLE (2), 3/8SBV VALVE (1), 3/8SSC COUPLING (1), X92-V VALVE ASSEMBLY (1), X94WM-CAP CAP ASSEMBLY (1)
X94WM-CAP	94WM CAP COMPLETE	94-A CAP (1), 94-E ADAPTER (1)
X92-VALVE	VALVE ASSEMBLY COMPLETE	92-V VALVE (1), 88-12 O-RING (1), 92-P PISTON (1), 92-S SPRING (1), 92-O O-RING (1), 92-OO O-RING (1), 92-C CLIP (2)
Z94WM-93WM-CONV	94WM VALVE TO CONVERT 93WM	X92-VALVE VALVE ASSEMBLY (1), 3/8SSC COUPLING (1), X94WM-CAP CAP ASSEMBLY (1)

NOTE	DESCRIPTION
A	NOT SHOWN
C	SOLD AS REPLACEMENT PART
T	SEE Z94PR CUT SHEET FOR SAMPLING ROD INFORMATION

DISCLAIMER:
THE DRAWING IS THE PROPERTY OF THE KUPFERLE FOUNDRY COMPANY. IT IS NOT TO BE USED OR DUPLICATED WITHOUT THE PERMISSION OF THE OWNER.

LEGEND

- (X) → STANDARD TAG
- (X/Y) → TAG WITH Y QUANTITY

DRAWN	RPS	9/30/2020
CHECKED	DCL	10/8/2020
MODIFIED		

SIZE	SCALE
C	1/3

DWG NO	#94-WM Cut_Rev0
--------	-----------------



2511 NORTH 9TH ST.
ST. LOUIS, MO 63102
1-800-231-3990

SHEET	REV
1 OF 3	0

#94-WM CUT SHEET

(5/8" x 3/4" RESETTER)

PARTS LIST

ITEM	QTY	PART NUMBER	DESCRIPTION	NOTES
1	1	1/2 x 3/8HBSS	1/2" x 3/8" S.S. HEX BUSHING	
2	1	3/890SLSS	3/8" S.S. STREET ELBOW	
3	2	3/8CNSS	3/8" S.S. CLOSE NIPPLE	
4	1	3/8SBV	3/8" S.S. BALL VALVE	C
5	1	3/8SSC	3/8" S.S. COUPLING	
6	1	88-12	PLUNGER O-RING	
7	2	92-C	RETAINING E-CLIP	
8	1	92-O	SAMPLING VALVE TOP O-RING	
9	1	92-OO	PLUNGER TIP O-RING	
10	1	92-P	SAMPLING VALVE PLUNGER PISTON	
11	1	92-S	SPRING	
12	1	92-V	SAMPLING VALVE BODY	
13	1	94-A	3/4" SCH. 40 PVC CAP	
14	1	94-D	BRASS DUAL CHECK VALVE	C
15	1	94-E	3/4" SCH. 40 PVC ADAPTER	
16	1	94-R	METER RESETTER (5/8" x 3/4")	C
OPTIONAL/REPAIR PARTS LIST				
17	0	94-I	BRASS IDLER (5/8" x 3/4")	C
18	0	95WM-I	PVC IDLER (5/8" X 3/4")	C

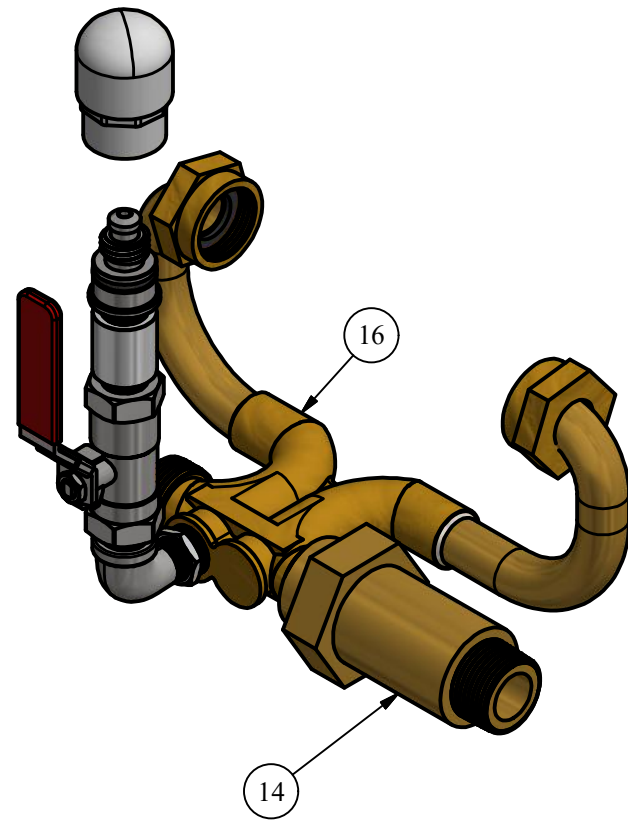
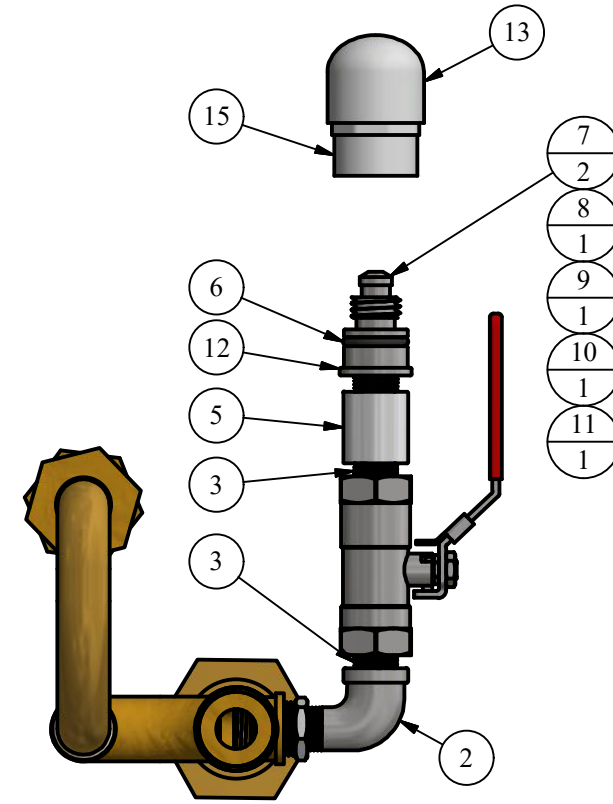

Z94PR ASSEMBLY (NOTE T)

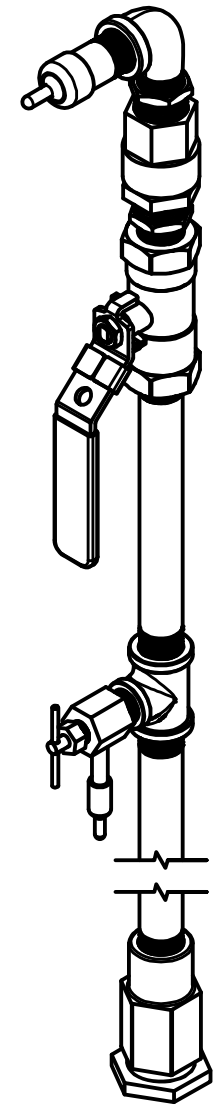

OPTIONAL 95WM-I PVC IDLER

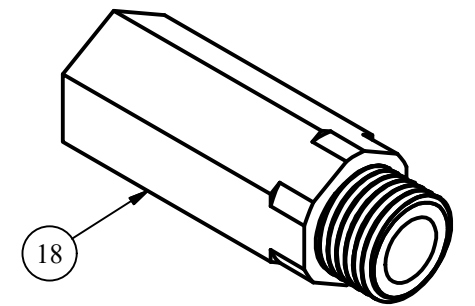

OPTIONAL 94-I BRASS IDLER

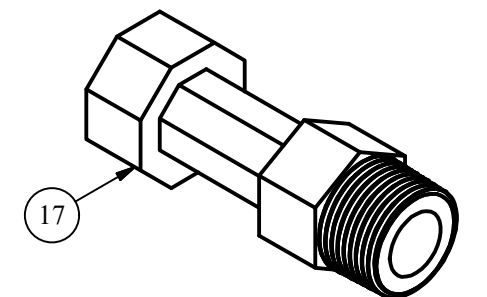

X94WM-ASSY ASSEMBLY

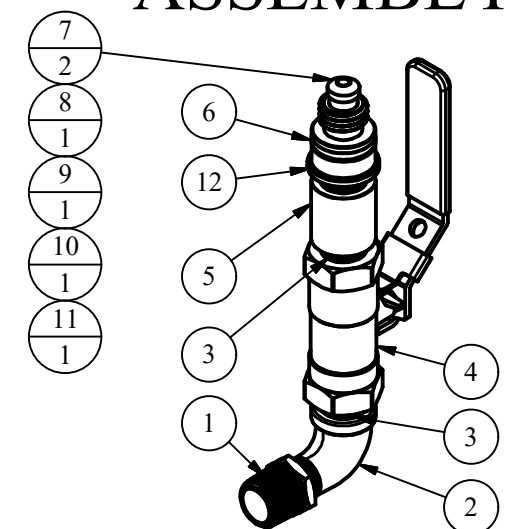

REPAIR KITS

PART NUMBER	DESCRIPTION	PARTS INCLUDED
X94WM-ASSY	94WM SAMPLING ASSEMBLY	1/2 X 3/8HBSS BUSHING (1), 3/890SLSS ELBOW (1), 3/8SSCN CLOSE NIPPLE (2), 3/8SBV VALVE (1), 3/8SSC COUPLING (1), X92-V VALVE ASSEMBLY (1), X94WM-CAP CAP ASSEMBLY (1)
X94WM-CAP	94WM CAP COMPLETE	94-A CAP (1), 94-E ADAPTER (1)
X92-VALVE	VALVE ASSEMBLY COMPLETE	92-V VALVE (1), 88-12 O-RING (1), 92-P PISTON (1), 92-S SPRING (1), 92-O O-RING (1), 92-OO O-RING (1), 92-C CLIP (2)
Z94WM-93WM-CONV	94WM VALVE TO CONVERT 93WM	X92-VALVE VALVE ASSEMBLY (1), 3/8SSC COUPLING (1), X94WM-CAP CAP ASSEMBLY (1)

NOTE	DESCRIPTION
A	NOT SHOWN
C	SOLD AS REPLACEMENT PART
T	SEE Z94PR CUT SHEET FOR SAMPLING ROD INFORMATION

DISCLAIMER:
THE DRAWING IS THE PROPERTY OF THE KUPFERLE FOUNDRY COMPANY. IT IS NOT TO BE USED OR DUPLICATED WITHOUT THE PERMISSION OF THE OWNER.

LEGEND

- (X) → STANDARD TAG
- (X/Y) → TAG WITH Y QUANTITY

DRAWN	RPS	9/30/2020
CHECKED	DCL	10/8/2020
MODIFIED		

SIZE	SCALE
C	1/3

DWG NO	#94-WM Cut_Rev0
--------	-----------------



SHEET	REV
2 OF 3	0

#94-WM CUT SHEET

(1" RESETTER)

PARTS LIST

ITEM	QTY	PART NUMBER	DESCRIPTION	NOTES
1	1	1/2 x 3/8HBSS	1/2" x 3/8" S.S. HEX BUSHING	
2	1	3/890SLSS	3/8" S.S. STREET ELBOW	
3	2	3/8CNSS	3/8" S.S. CLOSE NIPPLE	
4	1	3/8SBV	3/8" S.S. BALL VALVE	C
5	1	3/8SSC	3/8" S.S. COUPLING	
6	1	88-12	PLUNGER O-RING	
7	2	92-C	RETAINING E-CLIP	
8	1	92-O	SAMPLING VALVE TOP O-RING	
9	1	92-OO	PLUNGER TIP O-RING	
10	1	92-P	SAMPLING VALVE PLUNGER PISTON	
11	1	92-S	SPRING	
12	1	92-V	SAMPLING VALVE BODY	
13	2	94-A	3/4" SCH. 40 PVC CAP	
14	2	94-E	3/4" SCH. 40 PVC ADAPTER	
15	1	94-R-2	METER RESETTER (1")	C

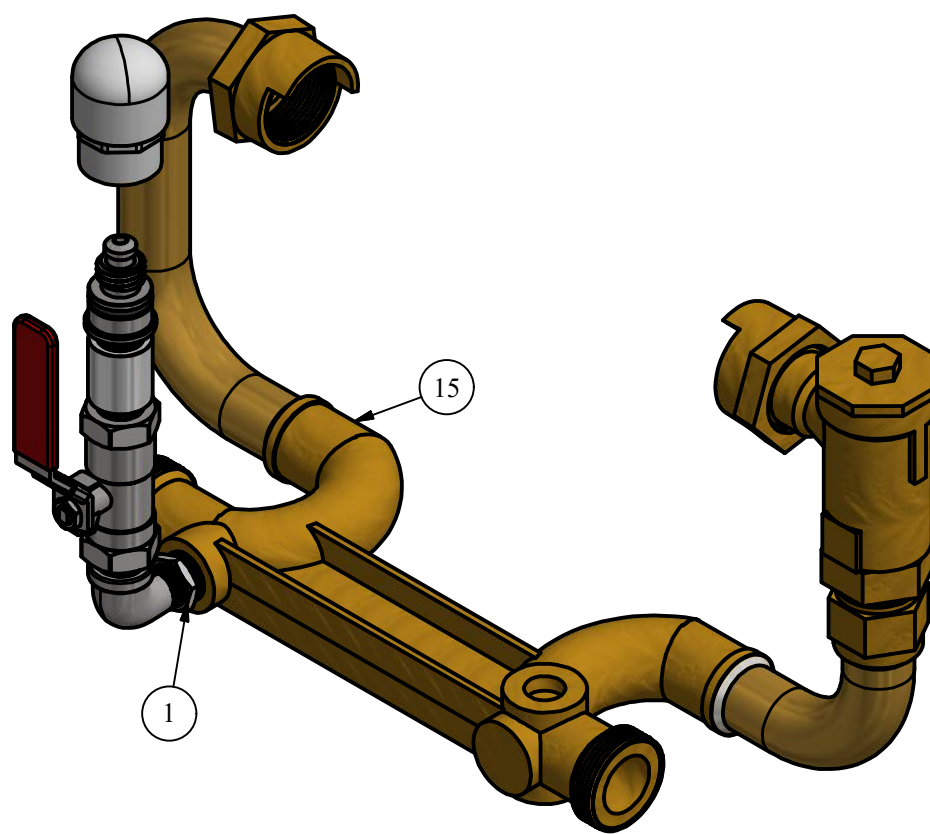
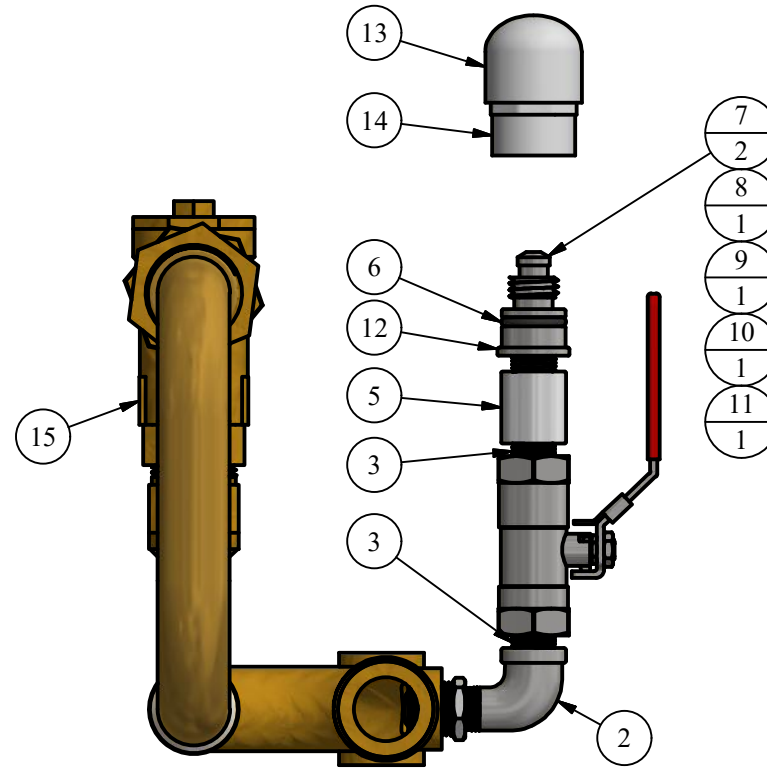

Z94PR ASSEMBLY (NOTE T)

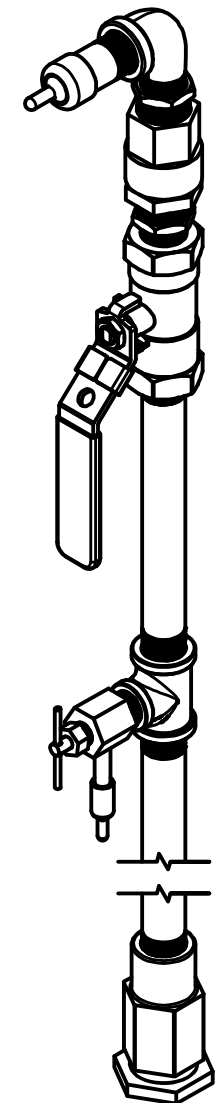

REPAIR KITS

PART NUMBER	DESCRIPTION	PARTS INCLUDED
X94WM-ASSY	94WM SAMPLING ASSEMBLY	1/2 X 3/8HBSS BUSHING (1), 3/890SLSS ELBOW (1), 3/8SSCN CLOSE NIPPLE (2), 3/8SBV VALVE (1), 3/8SSC COUPLING (1), X92-V VALVE ASSEMBLY (1), X94WM-CAP CAP ASSEMBLY (1)
X94WM-CAP	94WM CAP COMPLETE	94-A CAP (1), 94-E ADAPTER (1)
X92-VALVE	VALVE ASSEMBLY COMPLETE	92-V VALVE (1), 88-12 O-RING (1), 92-P PISTON (1), 92-S SPRING (1), 92-O O-RING (1), 92-OO O-RING (1), 92-C CLIP (2)
Z94WM-93WM-CONV	94WM VALVE TO CONVERT 93WM	X92-VALVE VALVE ASSEMBLY (1), 3/8SSC COUPLING (1), X94WM-CAP CAP ASSEMBLY (1)

X94WM-ASSY ASSEMBLY

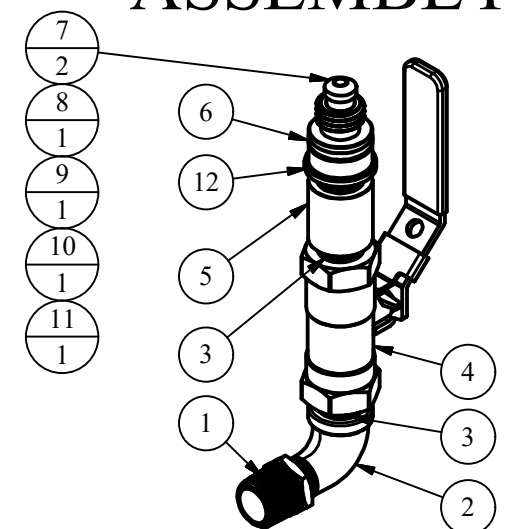

NOTE	DESCRIPTION
A	NOT SHOWN
C	SOLD AS REPLACEMENT PART
T	SEE Z94PR CUT SHEET FOR SAMPLING ROD INFORMATION

DISCLAIMER:
THE DRAWING IS THE PROPERTY OF THE KUPFERLE FOUNDRY COMPANY. IT IS NOT TO BE USED OR DUPLICATED WITHOUT THE PERMISSION OF THE OWNER.

LEGEND

- (X) → STANDARD TAG
- (X/Y) → TAG WITH Y QUANTITY

DRAWN	RPS	9/30/2020
CHECKED	DCL	10/8/2020
MODIFIED		

SIZE	SCALE
C	1/3

DWG NO	#94-WM Cut_Rev0
--------	-----------------



SHEET	3 OF 3	REV	0
-------	--------	-----	---

#94WM-ONE METER (1") RESETTER SAMPLING STATION SPEC SHEET

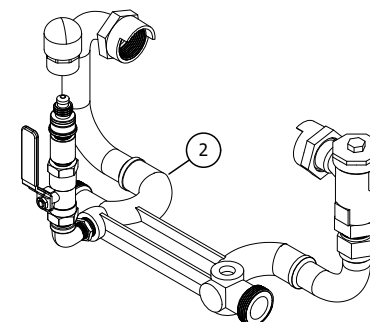
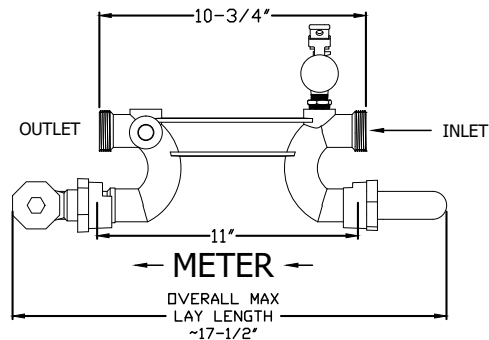
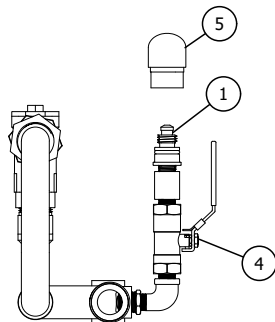
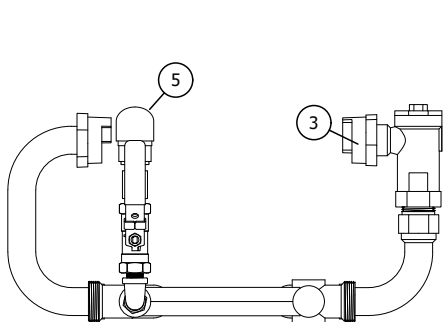

A FRONT VIEW
Scale: 1 1/2"=1'-0"

B SIDE HORN ANGLE VIEW
Scale: 1 1/2"=1'-0"

C WATER FLOW VIEW
Scale: 1 1/2"=1'-0"

D ISOMETRIC VIEW
Scale: 1 1/2"=1'-0"

#94WM-ONE Meter (1") Resetter Sampling Station Spec Sheet shall be installed in the following location(s):

ITEM	DESCRIPTION
1	S.S. MALE SPRING LOADED SAMPLING VALVE
2	94WM BODY (1")
3	1" EPDM RUBBER METER GASKET
4	3/8" LOCKABLE BALL VALVE
5	PVC COVER WITH CAP

Meter Resetter Sampling Station shall be meter box retrofit style for a 1" meter, with 1 1/4" NPS threaded inlet and outlet, both with a face for gasket seal. If desired the dual check valve (brass body) can be replaced with an idler/spacer option to be located between the water meter and residence.

To perform sampling, a portable rod (Kupferle Part # Z94PR) with a female coupler will thread onto the S.S. male spring loaded piston valve (#1) connected to the meter setter. This connection shall require a turning motion only, with no pushing or pulling necessary. Male valve shall be located before the water meter, have an auxiliary shut-off valve, and be protected by a PVC cover when not in use.

Unit model # shall be 94WM-ONE-S-BD as specified in the product ordering guide as manufactured by Kupferle Foundry Company, St. Louis MO, or approved equal.

RESETTER PRODUCT ORDERING GUIDE											
MODEL#	94WM	-	ONE	-	S	-	BD				
SUBSECTION	1		2		3		4				
SUBSECTION DESCRIPTION	MODEL #	SUBSECTION	OPTIONS	DESCRIPTIONS							
MODEL	1		94WM	BRASS RESETTER							
SIZE	2		ONE	1" METER							
			FxT	5/8" x 3/4" METER							
			FxH	5/8" x 1/2" METER							
SAMPLING OPTIONS	3		S	STANDARD SAMPLING ASSEMBLY							
			N	NONE (RESETTER CONFIGURATION)							
LAY LENGTH OPTIONS	4		N	NONE							
			BD	BRASS DUAL CHECK VALVE (INLINE)							

10/13/20	ISSUED FOR REFERENCE	MAXIMUM WORKING WATER PRESSURE: 175 PSI TEMPERATURE RANGE: 32° TO 140°F
DATE	STATUS / REVISION	

	INITIALS	DATE
DRAWN	DCL	10/13/20
APPROVED	DCL	10/30/20
MODIFIED		
#94WM-ONE (1") RESETTER SAMPLING STATION	SHEET SIZE	SCALE
	A (11x8.5)	1-1/2"=1'



KUPFERLE
Since 1857

2511 NORTH 9TH STREET
ST. LOUIS, MO 63102
1-800-231-3990
FAX 314-231-2820
www.hydrants.com

SHEET 1 OF 1