

MALLEABLE FITTINGS

CLASS 150



SPECIFICATIONS:

- **MATERIAL:** ASTM A 197 (CUPOLA)
- **DIMENSIONS:** ANSI B 16.3, B 16.4, B 16.39
- **UNION DIMENSIONS:** ASME B16.39
- **THREADS:** ANSI/ASME B 1.20, BS
- **CLASS:** 150
- **TENSILE STRENGTH:** 28.4 kg/mm. (Minimum)
- **ELONGATION:** 5% Minimum
- **ZINC COATING:** SI 918, ASTM A153

**MALLEABLE IRON THREADED PIPE UNIONS
PRESSURE - TEMPERATURE RATINGS**

Temperature		Pressure	
		Class 150	
(°F)	(°C)	psi	bar
-20° to 150°	-28.9° to 65.6°	300	20.7
200°	93.3°	265	18.3
250°	121.1°	225	15.5
300°	148.9°	185	12.8
350°	176.7°	150	10.3
400°	204.4°	110	7.6
450°	232.2°	75	5.2
500°	260.0°	-	-
550°	287.8°	-	-

**MALLEABLE IRON THREADED PIPE FITTINGS
PRESSURE - TEMPERATURE RATINGS**

Temperature		Pressure	
		Class 150	
(°F)	(°C)	psi	bar
-20° to 150°	-28.9° to 65.6°	300	20.7
200°	93.3°	265	18.3
250°	121.1°	225	15.5
300°	148.9°	185	12.8
350°	176.7°	150	10.3
400°	204.4°	-	-
450°	232.2°	-	-
500°	260.0°	-	-
550°	287.8°	-	-

MALLEABLE FITTINGS

CLASS 150 lbs.

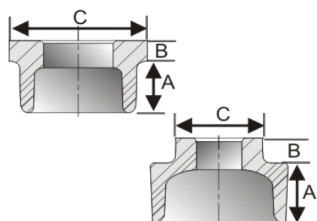

BUSHINGS MODEL LVMIB

Size	A	B	C	Inner Carton	Master	Pallet	Weight
1/4 X 1/8	0.52	0.15	0.64	120	1440	69120	0.02
3/8 X 1/8	0.48	0.16	0.85	75	900	43200	0.05
3/8 X 1/4	0.48	0.16	0.84	75	900	43200	0.04
1/2 X 1/8	0.65	0.19	1.03	150	600	28800	0.08
1/2 X 1/4	0.56	0.19	1.03	150	600	28800	0.08
1/2 X 3/8	0.56	0.19	1.03	150	600	28800	0.07
3/4 X 1/8	0.63	0.22	1.15	75	300	14400	0.14
3/4 X 1/4	0.63	0.22	1.15	75	300	14400	0.13
3/4 X 3/8	0.63	0.22	1.15	75	300	14400	0.13
3/4 X 1/2	0.71	0.22	1.15	75	300	14400	0.10
3/4 X 1/2	0.71	0.22	1.15	75	300	14400	0.10
1 X 1/8	0.75	0.38	1.12	50	200	9600	0.21
1 X 1/4	0.75	0.38	1.12	50	200	9600	0.22
1 X 3/8	0.75	0.38	1.12	50	200	9600	0.19
1 X 1/2	0.85	0.25	1.42	50	200	9600	0.21
1 X 3/4	0.85	0.25	1.42	50	200	9600	0.17
1-1/4 X 1/8	0.90	0.34	1.12	30	120	5760	0.33
1-1/4 X 1/4	0.90	0.34	1.12	30	120	5760	0.30
1-1/4 X 3/8	0.90	0.34	1.12	30	120	5760	0.29
1-1/4 X 1/2	0.90	0.34	1.24	30	120	5760	0.29
1-1/4 X 3/4	0.80	0.28	1.76	30	120	5760	0.34
1-1/4 X 1	0.80	0.28	1.76	30	120	5760	0.29
1-1/2 X 1/8	0.93	0.37	1.12	25	75	3600	0.47
1-1/2 X 1/4	0.93	0.37	1.12	25	75	3600	0.40
1-1/2 X 3/8	0.93	0.37	1.12	25	75	3600	0.39
1-1/2 X 1/2	0.93	0.37	1.34	25	75	3600	0.37
1-1/2 X 3/4	0.93	0.37	1.44	25	75	3600	0.40
1-1/2 X 1	0.92	0.31	2.00	25	75	3600	0.45
1-1/2 X 1-1/4	0.92	0.31	2.00	25	75	3600	0.32
2 X 1/4	0.86	0.42	1.12	20	60	2880	0.58
2 X 3/8	0.88	0.39	1.12	20	60	2880	0.57
2 X 1/2	0.98	0.41	1.34	20	60	2880	0.50

MALLEABLE FITTINGS

CLASS 150 lbs.



BUSHINGS

MODEL LVMIB (CONTINUED)

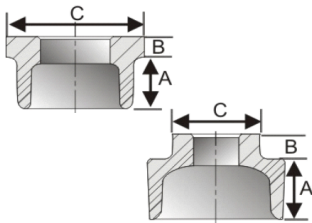

Size	A	B	C	Inner Carton	Master	Pallet	Weight
2 X 3/4	0.98	0.41	1.63	20	60	2880	0.63
2 X 1	0.98	0.41	1.77	20	60	2880	0.66
2 X 1-1/4	1.06	0.43	2.48	20	60	2880	0.74
2 X 1-1/2	1.06	0.43	2.48	20	60	2880	0.59
2-1/2 X 1/2	1.07	0.44	1.34	15	30	1440	0.95
2-1/2 X 3/4	1.07	0.44	1.63	15	30	1440	0.93
2-1/2 X 1	1.07	0.44	1.95	15	30	1440	0.96
2-1/2 X 1-1/4	1.07	0.44	2.39	15	30	1440	1.01
2-1/2 X 1-1/2	1.07	0.44	2.98	15	30	1440	1.13
2-1/2 X 2	1.17	0.37	2.98	15	30	1440	0.97
3 X 1/2	1.13	0.48	1.34	6	12	576	1.34
3 X 3/4	1.13	0.48	1.63	6	12	576	1.40
3 X 1	1.13	0.48	1.95	12	24	1152	1.44
3 X 1-1/4	1.13	0.48	2.39	12	24	1152	1.41
3 X 1-1/2	1.13	0.48	2.68	12	24	1152	1.61
3 X 2	1.13	0.48	3.86	10	20	1152	2.17
3 X 2-1/2	1.13	0.48	3.86	12	24	1152	1.64
3 X 1	1.13	0.48	1.95	12	24	1152	1.47
3-1/2 X 1-1/2	1.18	0.52	2.76	8	16	768	1.73
3-1/2 X 3	1.18	0.43	4.62	8	16	768	1.99
4 X 3/4	1.50	0.51	4.76	5	10	480	3.23
4 X 1	1.22	0.60	2.44	5	10	480	3.79
4 X 1-1/4	1.22	0.60	2.56	3	6	288	2.50
4 X 1-1/2	1.22	0.60	2.68	5	10	480	2.46
4 X 2	1.42	0.60	3.28	5	10	480	3.10
4 X 2-1/2	1.22	0.60	3.86	5	10	480	3.35
4 X 3	1.46	0.55	4.96	5	10	480	3.54
5 X 4	1.64	0.61	5.78	2	4	192	4.78
6 X 2	1.40	0.75	3.28	2	4	192	6.00
6 X 3	1.40	0.75	4.62	2	4	192	7.07
6 X 4	1.57	0.75	5.79	2	4	192	7.10
6 X 5	1.40	0.75	7.05	3	2	384	7.20

MALLEABLE FITTINGS

CLASS 150 lbs.

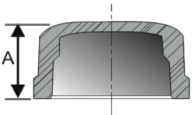

CAP

MODEL LVMICP

Size (in)	A	Inner Carton	Master	Pallet	Weight
1/8	0.55	120	1440	69120	0.03
1/4	0.63	60	720	46080	0.06
3/8	0.74	50	600	34560	0.08
1/2	0.87	75	300	14400	0.11
3/4	0.97	40	160	7680	0.17
1	1.16	25	100	4800	0.31
1-1/4	1.28	20	80	3840	0.46
1-1/2	1.33	18	54	2592	0.55
2	1.45	12	36	1728	0.82
2-1/2	1.70	16	32	1920	1.55
3	1.80	10	20	1152	2.39
4	2.08	6	12	576	3.81
5	2.32	4	8	480	5.77
6	2.55	2	4	192	9.09

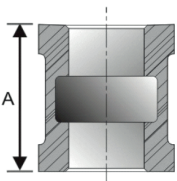

COUPLING

MODEL LVMICG

Size (in)	A	Inner Carton	Master	Pallet	Weight
1/8	0.96	70	840	40320	0.05
1/4	1.06	40	480	23040	0.09
3/8	1.16	60	360	23040	0.14
1/2	1.34	60	240	11520	0.18
3/4	1.52	50	150	7200	0.27
1	1.67	25	100	4800	0.40
1-1/4	1.93	16	64	3072	0.60
1-1/2	2.15	18	36	1728	0.87
2	2.54	12	24	1152	1.39
2-1/2	2.88	8	16	768	2.43
3	3.18	12	12	576	3.26
4	3.69	3	6	288	5.70
5	3.75	1	2	96	8.84

MALLEABLE FITTINGS

CLASS 150 lbs.



CROSS

MODEL LVMICR

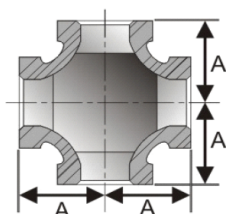

Size (in)	A	Inner Carton	Master	Pallet	Weight
1/8	0.69	30	180	8640	0.11
1/4	0.80	40	240	11520	0.18
3/8	0.95	25	150	7200	0.26
1/2	1.12	30	90	4320	0.41
3/4	1.31	20	60	2880	0.60
1	1.50	15	30	1440	0.99
1-1/4	1.75	10	20	960	1.44
1-1/2	1.94	8	16	768	1.84
2	2.25	5	10	480	2.88
2-1/2	2.70	3	6	288	5.41
3	3.08	2	4	384	7.35
4	3.79	2	4	192	12.74
6	5.20	1	1	48	28.66



EXTENSION PIECES

MODEL LVMIEX

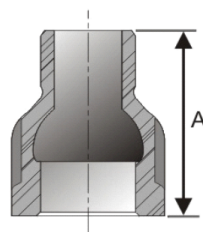

Size (in)	A	Inner Carton	Master	Pallet	Weight
1/2	1.57	70	280	14400	0.18
3/4	1.89	40	160	7680	0.28
1	2.17	30	90	4320	0.45
1-1/4	2.36	30	60	2880	0.67
1-1/2	2.56	20	40	1920	0.95
2	2.76	15	30	1440	1.28

MALLEABLE FITTINGS

CLASS 150 lbs.

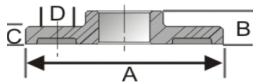

FLOOR FLANGES

MODEL LVMIFF

Size (in)	A	B	C	D	Inner Carton	Master	Pallet	Weight
1/4	2.37	0.46	0.28	0.251968504	10	30	1440	0.62
3/8	3.50	0.56	0.28	0.251968504	25	75	3600	0.58
1/2	3.50	0.50	0.28	0.251968504	25	50	2400	0.63
3/4	3.50	0.63	0.31	0.251968504	15	45	2160	0.76
1	4.00	0.69	0.34	0.251968504	15	30	1440	1.01
1-1/4	4.00	0.75	0.34	0.251968504	10	30	1440	1.01
1-1/2	4.50	0.87	0.37	0.311023622	8	24	1152	1.39
2	5.50	1.00	0.41	0.311023622	8	16	768	2.15

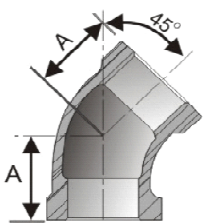

45° ELBOW

MODEL LVMIHL

Size (in)	A	Inner	Master	Pallet	Weight
1/8	0.63	50	600	28800	0.07
1/4	0.73	30	360	17280	0.10
3/8	0.80	75	300	14400	0.14
1/2	0.88	50	200	9600	0.22
3/4	0.98	40	120	5760	0.32
1	1.12	20	60	2880	0.54
1-1/4	1.29	20	40	1920	0.75
1-1/2	1.43	10	30	1440	1.01
2	1.68	12	24	1152	1.60
2-1/2	1.95	12	12	576	2.87
3	2.17	10	10	480	4.48
4	2.61	4	4	192	7.72
5	3.05	1	2	96	10.69
6	3.46	1	1	48	17.26

MALLEABLE FITTINGS

CLASS 150 lbs.

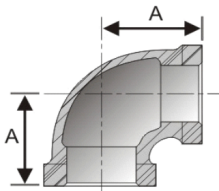

90° ELBOW MODEL LVMIL

Size (in)	A	Inner	Master	Pallet	Weight
1/8	0.69	50	600	28800	0.07
1/4	0.81	35	420	20160	0.11
3/8	0.95	80	320	17280	0.16
1/2	1.12	50	200	9600	0.22
3/4	1.31	35	105	5040	0.39
1	1.50	20	60	2880	0.61
1-1/4	1.75	20	40	1920	0.85
1-1/2	1.94	15	30	1440	1.10
2	2.25	8	16	768	1.72
2-1/2	2.70	12	12	576	3.17
3	3.08	8	8	384	4.87
4	3.79	2	2	96	8.21
5	4.50	2	2	96	15.45
6	5.13	1	1	48	20.41

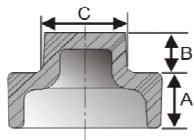

PLUG MODEL LVMIP

Size (in)	A	B	C	Master	Pallet	Weight
1/8	0.39	0.24	0.28	2400	115200	0.02
1/4	0.46	0.28	0.37	1200	86400	0.03
3/8	0.50	0.31	0.43	960	57600	0.05
1/2	0.58	0.38	0.56	600	28800	0.08
3/4	0.65	0.44	0.63	360	17280	0.10
1	0.75	0.50	0.82	240	11520	0.20
1-1/4	0.82	0.56	0.94	120	5760	0.34
1-1/2	0.85	0.62	1.13	90	4320	0.48
2	0.91	0.68	1.31	60	2880	0.74
2-1/2	1.26	0.74	1.50	32	1536	1.01
3	1.16	0.80	1.69	28	1536	1.66
4	1.22	1.00	2.28	12	576	3.10
5	1.31	1.00	2.50	7	480	6.35
6	1.40	1.25	3.03	4	480	10.66

MALLEABLE FITTINGS

CLASS 150 lbs.



REDUCING COUPLING

MODEL LVMIRC

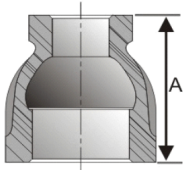

Size (in)	A	Inner	Master	Pallet	Weight
1/4 X 1/8	1.00	50	600	28800	.07
3/8 X 1/8	1.13	50	600	28800	.09
3/8 X 1/4	1.13	50	600	28800	.11
1/2 X 1/8	1.25	50	600	28800	.14
1/2 X 1/4	1.25	50	600	28800	.14
1/2 X 3/8	1.25	50	600	28800	.16
3/4 X 1/8	1.44	50	600	28800	.21
3/4 X 1/4	1.44	50	600	28800	.22
3/4 X 3/8	1.44	50	600	28800	.21
3/4 X 1/2	1.44	50	600	28800	.24
1 X 1/4	1.69	50	600	28800	.32
1 X 3/8	1.69	50	600	28800	.37
1 X 1/2	1.69	50	600	28800	.30
1 X 3/4	1.69	50	600	28800	.37
1-1/4 X 3/8	2.06	50	600	28800	.85
1-1/4 X 1/2	2.06	50	600	28800	.55
1-1/4 X 3/4	2.06	50	600	28800	.61
1-1/4 X 1	2.06	50	600	28800	.62
1-1/2 X 3/8	2.31	50	600	28800	.66
1-1/2 X 1/2	2.31	50	600	28800	.70
1-1/2 X 3/4	2.31	50	600	28800	.74
1-1/2 X 1	2.31	50	600	28800	.78
1-1/2 X 1-1/4	2.31	50	600	28800	.87
2 X 1/2	2.81	50	600	28800	1.14
2 X 3/4	2.81	12	36	1728	1.15
2 X 1	2.81	12	36	1728	1.18
2 X 1-1/4	2.81	9	27	1296	1.18
2 X 1-1/2	2.81	9	27	1296	1.35
2-1/2 X 1/2	3.25	10	20	960	1.72
2-1/2 X 3/4	3.25	10	20	960	2.34
2-1/2 X 1	3.25	10	20	960	1.79
2-1/2 X 1-1/4	3.25	10	20	960	2.20
2-1/2 X 1-1/2	3.25	7	14	672	2.09
2-1/2 X 2	3.25	7	14	672	2.26
2-1/2 X 2	3.25	7	14	672	2.26
3 X 3/4	3.69	6	12	576	2.82
3 X 1	3.69	6	12	576	3.04
3 X 1-1/4	3.69	6	12	576	3.15
3 X 1-1/2	3.69	6	12	576	3.27
3 X 2	3.69	6	12	576	3.25
3 X 2-1/2	3.69	5	10	480	3.64
4 X 1-1/2	4.38	3	6	288	5.43
4 X 2	4.38	3	6	288	5.35
4 X 2-1/2	4.38	3	6	288	5.69
4 X 3	4.38	3	6	288	5.90
6 X 4	5.81	2	2	96	13.17

MALLEABLE FITTINGS

CLASS 150 lbs.



REDUCING ELBOW MODEL LVMIRE

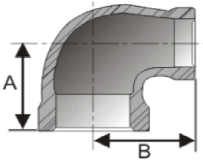

Size (in)	A	B	Inner	Master	Pallet	Weight
1/4 X 1/8	0.74	0.76	40	480	23040	0.09
3/8 X 1/8	0.81	0.85	105	420	20160	0.11
3/8 X 1/4	0.88	0.90	80	320	17280	0.15
1/2 X 1/8	1.04	1.03	60	240	11520	0.15
1/2 X 1/4	0.97	0.98	60	240	11520	0.19
1/2 X 3/8	1.04	1.03	50	200	11520	0.22
3/4 X 1/8	1.03	1.01	40	160	7680	0.23
3/4 X 1/4	1.05	1.08	40	160	7680	0.27
3/4 X 1/4	1.05	1.08	40	160	7680	0.27
3/4 X 3/8	1.12	1.13	40	160	7680	0.28
3/4 X 1/2	1.20	1.22	40	160	7680	0.31
1 X 1/4	1.18	1.26	25	150	7200	0.31
1 X 3/8	1.18	1.27	30	120	7200	0.40
1 X 1/2	1.26	1.40	25	100	4800	0.48
1 X 3/4	1.37	1.45	50	100	4800	0.49
1-1/4 X 1/2	1.34	1.53	20	80	3840	0.60
1-1/4 X 3/4	1.45	1.62	15	60	2880	0.69
1-1/4 X 1	1.58	1.67	10	40	1920	0.80
1-1/2 X 1/2	1.38	1.65	15	60	2880	0.75
1-1/2 X 3/4	1.52	1.75	10	40	1920	0.92
1-1/2 X 1	1.65	1.80	10	40	1920	0.98
1-1/2 X 1-1/4	1.82	1.88	15	30	1440	1.15
1-1/2 X 1-1/4	1.82	1.88	10	40	1920	1.06
1-1/2 X 1-1/4	1.82	1.88	9	36	1728	1.23
1-1/2 X 1-1/4	1.82	1.88	14	28	1344	1.17
1-1/2 X 1-1/4	1.90	2.10	10	20	960	1.58
2 X 1-1/4	1.90	2.10	10	20	960	1.58
2 X 1-1/2	2.02	2.16	10	20	960	1.67
2-1/2 X 1/2	1.77	2.36	5	15	1440	1.72
2-1/2 X 3/4	1.89	2.36	6	24	1440	1.94
2-1/2 X 1	2.17	2.48	10	20	1440	2.09
2-1/2 X 1-1/4	2.04	2.45	8	16	768	2.38
2-1/2 X 1-1/2	2.16	2.51	6	12	576	2.63
2-1/2 X 2	2.39	2.60	6	12	576	2.80
3 X 1-1/2	2.28	2.80	4	8	384	3.19
3 X 2	2.52	2.89	4	8	384	3.80
3 X 2-1/2	2.83	2.99	4	8	384	4.75
4 X 2	2.72	3.44	2	4	192	5.05
4 X 2-1/2	3.04	3.51	2	4	192	5.91
4 X 3	3.30	3.20	2	4	192	6.78

MALLEABLE FITTINGS

CLASS 150 lbs.



REDUCING TEE MODEL LVMIRT

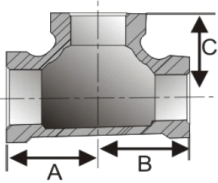

Size (in)	A	B	C	Inner	Master	Pallet	Weight
1/4 X 1/4 X 1/8	0.74	0.74	0.76	25	300	14400	0.13
3/8 X 3/8 X 1/8	0.88	0.81	0.85	45	180	11520	0.26
3/8 X 3/8 X 1/4	0.88	0.88	0.90	60	240	11520	0.19
1/2 X 1/2 X 1/8	0.86	0.87	0.94	45	90	4320	0.26
1/2 X 1/2 X 1/4	0.97	0.97	0.98	40	160	7680	0.28
1/2 X 1/2 X 3/8	1.04	1.04	1.03	40	160	7680	0.29
1/2 X 1/2 X 3/4	1.20	1.20	1.28	30	120	5760	0.40
1/2 X 1/2 X 1	1.36	1.36	1.26	20	80	4800	0.53
3/4 X 3/4 X 1/4	1.05	1.05	1.08	25	100	4800	0.37
3/4 X 3/4 X 3/8	1.12	1.12	1.13	25	100	4800	0.42
3/4 X 3/4 X 1/2	1.20	1.20	1.18	20	80	3840	0.42
3/4 X 3/4 X 1	1.45	1.45	1.37	30	60	3840	0.71
3/4 X 3/4 X 1-1/4	1.63	1.63	1.45	30	60	3840	0.77
1 X 1 X 1/4	1.11	1.11	1.22	20	80	3840	0.53
1 X 1 X 3/8	1.18	1.18	1.27	15	60	2880	0.63
1 X 1 X 1/2	1.26	1.26	1.40	15	60	2880	0.64
1 X 1 X 3/4	1.37	1.37	1.45	12	48	2304	0.72
1 X 1 X 1-1/4	1.67	1.67	1.58	11	44	2112	1.03
1 X 1 X 1-1/2	1.80	1.80	1.65	9	36	1728	1.12
1 X 1 X 2	1.98	1.98	1.89	8	32	2880	1.44
1-1/4 X 1-1/4 X 3/8	1.26	1.26	1.44	20	40	1920	0.84
1-1/4 X 1-1/4 X 1/2	1.34	1.34	1.45	20	40	1920	0.93
1-1/4 X 1-1/4 X 3/4	1.45	1.45	1.62	20	40	1920	0.99
1-1/4 X 1-1/4 X 1	1.58	1.58	1.66	20	40	1920	1.08
1-1/4 X 1-1/4 X 1-1/2	1.88	1.88	1.82	12	24	1152	1.53
1-1/4 X 1-1/4 X 2	2.10	2.10	1.90	7	28	1536	1.68
1-1/2 X 1-1/2 X 3/8	1.58	1.58	1.58	15	30	1440	1.03
1-1/2 X 1-1/2 X 1/2	1.41	1.41	1.66	18	36	1728	1.09
1-1/2 X 1-1/2 X 3/4	1.41	1.41	1.75	15	30	1440	1.24
1-1/2 X 1-1/2 X 1	1.65	1.65	1.88	10	30	1440	1.34
1-1/2 X 1-1/2 X 1-1/4	1.65	1.65	1.88	12	24	1152	1.49
1-1/2 X 1-1/2 X 2	2.12	2.12	1.98	8	16	768	1.98
2 X 2 X 1/2	1.49	1.49	1.88	10	20	960	1.57
2 X 2 X 3/4	1.60	1.60	1.97	10	20	960	1.75
2 X 2 X 1	1.73	1.73	2.02	10	20	960	1.84
2 X 2 X 1-1/4	1.86	1.86	2.06	8	16	768	2.04
2 X 2 X 1-1/2	1.98	1.98	2.12	8	16	768	2.23
2 X 2 X 2-1/2	2.55	2.55	2.34	6	12	576	3.36
2-1/2 X 2-1/2 X 1/2	1.58	1.58	2.20	6	12	576	2.72
2-1/2 X 2-1/2 X 3/4	1.74	1.74	2.32	6	12	576	2.72
2-1/2 X 2-1/2 X 1	1.74	1.74	2.37	5	10	480	2.78
2-1/2 X 2-1/2 X 1-1/4	1.87	1.87	2.45	5	10	480	3.35
2-1/2 X 2-1/2 X 1-1/2	2.16	2.16	2.51	5	10	480	3.58
2-1/2 X 2-1/2 X 2	2.39	2.39	2.60	4	8	384	3.84

MALLEABLE FITTINGS

CLASS 150 lbs.



REDUCING TEE MODEL LVMIRT (CONTINUED)

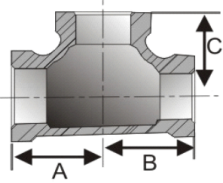

Size (in)	A	B	C	Inner	Master	Pallet	Weight
3 X 3 X 1/2	1.83	1.83	2.56	4	8	384	4.20
3 X 3 X 3/4	1.79	1.79	2.57	3	9	432	4.16
3 X 3 X 1	2.00	2.00	2.66	3	6	288	4.25
3 X 3 X 1-1/4	2.17	2.17	2.74	3	6	288	4.49
3 X 3 X 1-1/2	2.29	2.29	2.81	3	6	288	4.73
3 X 3 X 2	2.52	2.52	2.89	3	6	288	5.31
3 X 3 X 2-1/2	2.83	2.83	2.99	3	6	288	5.81
4 X 4 X 1	*	*	*	2	4	192	6.08
4 X 4 X 1-1/4	2.40	2.40	3.41	2	4	192	7.02
4 X 4 X 1-1/2	2.46	2.46	3.25	2	4	192	6.87
4 X 4 X 2	2.69	2.69	3.34	3	3	144	7.70
4 X 4 X 2-1/2	3.05	3.05	3.51	3	3	144	8.84
4 X 4 X 3	3.23	3.23	3.53	2	2	96	10.06
1/2 X 1/4 X 1/2	1.12	0.98	1.12	25	100	4800	0.28
3/4 X 1/2 X 1/2	1.18	1.18	1.20	25	100	4800	0.40
3/4 X 1/2 X 3/4	1.28	1.20	1.28	20	80	3840	0.53
3/4 X 1/2 X 1	1.42	1.37	1.34	18	72	3456	0.55
1 X 1/2 X 1/2	1.24	1.10	1.37	20	80	3840	0.53
1 X 1/2 X 3/4	1.34	1.20	1.42	20	80	3840	0.61
1 X 1/2 X 1	1.47	1.37	1.47	15	60	2880	0.75
1 X 3/4 X 1/2	1.24	1.18	1.37	20	80	3840	0.57
1 X 3/4 X 3/4	1.34	1.28	1.42	15	60	2880	0.67
1 X 3/4 X 1	1.50	1.45	1.50	15	60	2880	0.81
1-1/4 X 1/2 X 3/4	1.46	1.26	1.56	25	50	2400	0.65
1-1/4 X 1/2 X 1	1.58	1.36	1.67	20	40	1920	0.93
1-1/4 X 1/2 X 1-1/4	1.72	1.50	1.72	20	40	1920	0.96
1-1/4 X 3/4 X 1/2	1.42	1.28	1.59	10	40	1920	0.66
1-1/4 X 3/4 X 3/4	1.42	1.28	1.59	10	40	1920	0.80
1-1/4 X 3/4 X 1	1.55	1.42	1.63	10	40	1920	0.89
1-1/4 X 3/4 X 1-1/4	1.75	1.62	1.75	10	40	1920	1.08
1-1/4 X 1 X 1/2	1.31	1.24	1.50	20	40	1920	0.74
1-1/4 X 1 X 3/4	1.42	1.34	1.59	20	40	1920	0.93
1-1/4 X 1 X 1	1.55	1.47	1.63	20	40	1920	1.05
1-1/4 X 1 X 1-1/4	1.75	1.67	1.75	15	30	1440	1.15
1-1/4 X 1 X 1-1/2	1.94	1.67	1.94	18	36	1920	1.38
1-1/2 X 1/2 X 3/4	1.44	1.12	1.68	15	30	1440	0.78
1-1/2 X 1/2 X 1	1.65	1.52	1.94	12	24	1152	0.98
1-1/2 X 1/2 X 1-1/4	1.89	1.73	1.97	12	24	1152	1.18
1-1/2 X 1/2 X 1-1/2	1.94	1.66	1.94	12	24	1152	1.37
1-1/2 X 3/4 X 1/2	1.40	1.16	1.67	15	30	1440	0.88
1-1/2 X 3/4 X 3/4	1.51	1.27	1.64	15	30	1440	1.09
1-1/2 X 3/4 X 1-1/4	1.79	1.57	1.93	12	24	1152	1.26
1-1/2 X 3/4 X 1-1/2	1.90	1.72	1.90	12	24	1152	1.39
1-1/2 X 1 X 1/2	1.44	1.25	1.69	15	30	1440	1.21
1-1/2 X 1 X 3/4	1.49	1.35	1.73	15	30	1440	1.30
1-1/2 X 1 X 1	1.65	1.50	1.80	15	30	1440	1.18

MALLEABLE FITTINGS

CLASS 150 lbs.

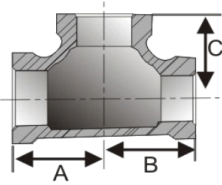

REDUCING TEE MODEL LVMIRT (CONTINUED)

Size (in)	A	B	C	Inner	Master	Pallet	Weight
1-1/2 X 1 X 1	1.65	1.50	1.80	15	30	1440	1.18
1-1/2 X 1 X 1-1/4	1.82	1.67	1.88	12	24	1152	1.23
1-1/2 X 1 X 1-1/2	1.94	1.80	1.94	12	24	1152	1.57
1-1/2 X 1-1/4 X 1/2	1.41	1.34	1.66	12	24	1152	1.08
1-1/2 X 1-1/4 X 3/4	1.52	1.43	1.75	12	24	1152	1.09
1-1/2 X 1-1/4 X 1	1.63	1.55	1.76	12	24	1152	1.25
1-1/2 X 1-1/4 X 1-1/4	1.82	1.75	1.88	12	24	1152	1.40
1-1/2 X 1-1/4 X 1-1/2	1.90	1.84	1.90	12	24	1152	1.63
2 X 1/2 X 2	2.21	1.84	2.21	8	16	768	2.08
2 X 3/4 X 3/4	1.63	1.30	1.93	12	24	1152	1.03
2 X 3/4 X 2	2.25	1.97	2.25	8	16	768	2.12
2 X 1 X 1	1.73	1.57	2.09	12	24	1152	1.45
2 X 1 X 1-1/2	1.98	1.76	2.12	10	20	960	1.71
2 X 1 X 2	2.21	1.98	2.21	8	16	768	2.18
2 X 1-1/4 X 1	1.81	1.57	2.03	8	16	768	1.75
2 X 1-1/4 X 1-1/4	1.86	1.72	2.06	8	16	768	1.66
2 X 1-1/4 X 1-1/2	2.09	1.88	2.16	8	16	768	1.87
2 X 1-1/4 X 2	2.25	2.10	2.25	8	16	768	2.22
2 X 1-1/2 X 3/4	1.63	1.46	1.98	10	20	960	1.38
2 X 1-1/2 X 1	1.73	1.65	2.02	10	20	960	1.61
2 X 1-1/2 X 1-1/4	1.86	1.78	2.06	8	16	768	1.93
2 X 1-1/2 X 1-1/2	1.98	1.90	2.12	8	16	768	1.95
2 X 1-1/2 X 2	2.21	2.11	2.21	8	16	768	2.04
2-1/2 X 1-1/2 X 2-1/2	2.70	2.51	3.41	5	10	480	3.93
2-1/2 X 2 X 2	2.39	2.25	2.60	5	10	480	3.13
2-1/2 X 2 X 2-1/2	2.70	2.60	2.70	5	10	480	4.08

MALLEABLE FITTINGS

CLASS 150 lbs.

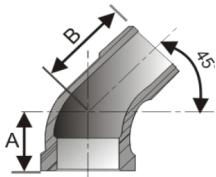

45° STREET ELBOW MODEL LVMISHL

Size (in)	A	B	Inner	Master	Pallet	Weight
1/8	0.63	0.83	70	840	40320	0.05
1/4	0.73	0.94	40	480	23040	0.09
3/8	0.80	1.03	120	360	19200	0.13
1/2	0.86	1.30	75	225	10800	0.19
3/4	0.96	1.48	40	120	5760	0.28
1	1.10	1.69	25	75	3600	0.48
1-1/4	1.26	1.87	10	40	1920	0.75
1-1/2	1.40	2.05	10	30	1440	1.05
2	1.65	2.38	12	24	1152	1.73
2-1/2	1.95	2.72	6	12	576	2.79
3	2.17	3.16	3	6	288	4.49
4	2.61	3.90	4	4	192	7.72

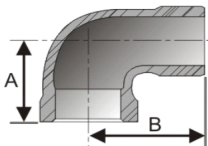

90° STREET ELBOW MODEL LVMISL

Size (in)	A	B	Inner	Master	Pallet	Weight
1/8	0.69	1.00	60	720	34560	0.06
1/4	0.80	1.17	35	420	20160	0.09
3/8	0.95	1.48	60	240	11520	0.15
1/2	1.10	1.59	60	180	8640	0.20
3/4	1.28	1.85	35	105	5040	0.39
1	1.47	2.10	40	80	4320	0.62
1-1/4	1.75	2.57	25	50	2400	0.97
1-1/2	1.90	2.63	9	27	1296	1.36
2	2.21	3.20	8	16	768	2.02
2-1/2	2.65	3.78	5	10	480	3.43
3	3.02	4.42	8	8	384	5.36
4	3.72	5.57	4	4	192	9.35
6	5.13	8.03	1	1	48	20.39

MALLEABLE FITTINGS

CLASS 150 lbs.



TEE

MODEL LVMIT

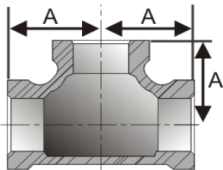

Size (in)	A	Inner	Master	Pallet	Weight
1/8	0.69	120	480	23040	0.10
1/4	0.81	75	300	14400	0.14
3/8	0.95	45	180	8640	0.22
1/2	1.12	40	120	5760	0.33
3/4	1.31	35	70	3360	0.49
1	1.50	20	40	1920	0.76
1-1/4	1.75	14	28	1344	1.24
1-1/2	1.94	12	24	1152	1.56
2	2.26	8	16	768	2.50
2-1/2	2.70	4	8	384	4.59
3	3.08	6	6	288	6.81
4	3.79	2	2	96	10.94
5	4.50	2	2	96	20.95
6	5.13	1	1	48	28.62



UNION

MODEL LVMIU

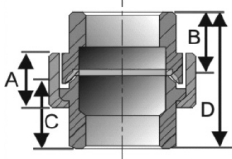

Size (in)	A	B	C	D	Inner	Master	Pallet	Weight
1/8	0.55	0.65	0.69	1.26	60	240	11520	0.14
1/4	0.61	0.73	0.80	1.44	18	216	11520	0.22
3/8	0.63	0.83	0.90	1.61	35	140	7680	0.32
1/2	0.67	0.91	1.00	1.72	50	100	4800	0.43
3/4	0.71	1.00	1.09	1.95	35	70	3360	0.62
1	0.79	1.06	1.18	2.20	20	40	1920	0.89
1-1/4	0.94	1.18	1.38	2.26	15	30	1440	1.38
1-1/2	1.00	1.30	1.50	2.41	10	20	960	1.74
2	1.06	1.46	1.61	2.75	6	12	576	2.60
2-1/2	1.16	1.65	1.77	3.22	4	8	384	4.57
3	1.28	1.85	1.97	3.50	4	8	384	6.07
4	1.54	2.28	2.38	3.85	2	4	192	11.08

PROJECT	APPROVAL STAMP
PROJECT:	<input type="checkbox"/> APPROVED
ADDRESS:	<input type="checkbox"/> APPROVED AS NOTED
ENGINEER:	<input type="checkbox"/> NOT APPROVED
SUBMITTAL DATA:	REMARKS:
NOTES 1:	
NOTES 2:	