

SUBMITTAL SHEET

DWV PVC

PVC Drain, Waste & Vent Fittings



LASCO Fittings, Inc., an Aalberts Industries company, specializes in the production and sale of injection molded fittings for Irrigation, Plumbing, Industrial, Pool/Spa and Retail markets. LASCO Fittings, Inc. operates a 26-acre manufacturing facility in Brownsville, TN. With eight Regional Distribution Facilities strategically located within the United States, LASCO provides worldwide distribution and overnight service.

Injection Molded PVC Pipe Fittings in sizes 1¼” through 12”

LASCO Fittings, Inc.'s comprehensive line of PVC fittings offers a variety of injection molded configurations in DWV PVC, sizes 1¼” through 12” conforming to ASTM D2665.

STANDARDS AND SPECIFICATIONS – Schedule 40 - DWV

- ASTM D2665 – Poly (Vinyl Chloride) (PVC) Plastic Drain, Waste, and Vent Pipe and Fittings.
- ASTM D1784 – Rigid Poly (Vinyl Chloride) (PVC) Compounds and Chlorinated Poly (Vinyl Chloride) (CPVC) Compounds.
- ASTM D3311 – Drain, Waste, and Vent (DWV) Plastic Fittings Patterns
- MATERIAL – LASCO DWV Fittings are produced from PVC Type I, Cell Classification 12454-B.
PVC Fittings are listed by NSF (National Sanitation Foundation). Product is certified to the Uniform Plumbing Code™.

DO NOT USE LASCO FITTINGS FOR COMPRESSED AIR OR GASES.
DO NOT TEST PVC PIPING SYSTEMS WITH COMPRESSED AIR OR GASES.
DO NOT USE FITTINGS WITH LIQUIDS NOT RECOMMENDED BY LASCO.
MODIFICATIONS OF FITTINGS VOIDS THE WARRANTY.



Limited Warranty

LASCO Fittings, Inc. products are warranted to be free from manufacturing defects in materials and workmanship. They are warranted against rot, rust, and electrolytic corrosion for a period of three years from date of installation. If LASCO products prove defective due to manufacturing defects in material or workmanship during that period, the manufacturer will provide new replacement units of the same type and size. No remedy will be granted under this warranty if LASCO products are not used strictly in accordance with LASCO's directions with respect to use and storage or if the products have been modified in any way. THE MANUFACTURER'S LIABILITY UNDER EXPRESSED OR IMPLIED WARRANTY OR FOR ANY REASON IS LIMITED TO FURNISHING REPLACEMENT UNITS OR GRANTING A CREDIT FOR DEFECTIVE UNITS. NO LABOR EXPENSE OR CONSEQUENTIAL DAMAGES WILL BE PAID BY LASCO. THIS WARRANTY IS IN LIEU OF ALL OTHER GUARANTEES AND WARRANTIES, EXPRESSED OR IMPLIED, INCLUDING BUT NOT LIMITED TO, WARRANTIES OF MERCHANTABILITY AND FITNESS FOR PURPOSE, EXCEPT FOR ANY WARRANTIES IMPLIED BY LAW FOR NONCOMMERCIAL CONSUMERS. ANY SUCH WARRANTIES ARE LIMITED TO THE DURATION OF THIS WRITTEN WARRANTY.

414 Morgan Street • Brownsville, TN 38012
(731) 772-3180 | www.lascofittings.com

This specification is provided for reference only. LASCO Fittings, Inc reserves the right to change any portion of this specification without notice and without incurring obligation to make such changes to LASCO products previously or subsequently sold. Please visit our website www.lascofittings.com for the most current information.

DWV - PVC

PVC Drain, Waste & Vent Fittings

DWV - PVC

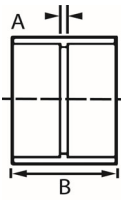

COUPLING

Part Number	Size	A	B
D100-012	1½	3/32	1 17/32
D100-015	1½	1/8	1 17/32
D100-020	2	1/8	1 5/8
D100-030	3	7/32	3 7/32
D100-040	4	3/32	3 25/32
D100-060	6	1/4	6 9/32
D100-080	8	5/16	9 5/16
D100-100	10	5/16	10 11/32
D100-120	12	5/16	12 3/8

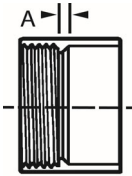

FEMALE ADAPTER

Part Number	Size	A
D101-012	1½	1/8
D101-015	1½	1/4
D101-020	2	1/4
D101-030	3	11/32
D101-040	4	1/8
D101-060	6	5/16

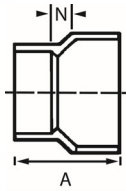

PIPE INCREASER - REDUCER

Part Number	Size	A	N
D102-251	2 x 1½	2 5/32	9/16
D102-337	3 x 1½	3 11/32	1
D102-338	3 x 2	3 5/32	3/4
D102-420	4 x 2	3 7/8	1 1/4
D102-422	4 x 3	4 9/32	15/16
D102-532	6 x 4	6 19/32	1 1/8
D102-582	8 x 4	8 15/16	2 13/32
D102-585	8 x 6	9	1
D102-626	10 x 6	10 25/32	2 23/32
D102-628	10 x 8	10 25/32	1 3/4
D102-668	12 x 8	12 27/32	2 23/32
D102-670	12 x 10	13	1 15/16

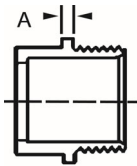

TRAP ADAPTER, MALE

Part Number	Size	A
D103-015	1½	5/32
D103-020	2	7/32
D103-212	1½ x 1¼	3/16

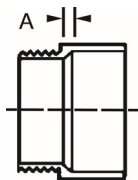

MALE ADAPTER

Part Number	Size	A
D109-012	1½	7/32
D109-015	1½	7/32
D109-020	2	3/16
D109-030	3	3/8
D109-040	4	7/16
D109-212	1½ x ¼	1/4

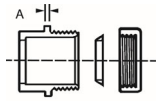

TRAP ADAPTER, MALE		
Part Number	Size	A
D113-012	1¼	3/16
D113-015	1½	5/32
D113-020	2	3/16
D113-212	1½ x 1¼	3/16

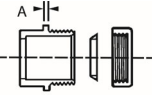

TRAP ADAPTER, MALE		
Part Number	Size	A
D115-015	1½	3/16
D115-020	2	3/16
D115-212	1½ x 1¼	3/16

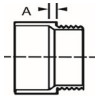

TRAP ADAPTER, FEMALE		
Part Number	Size	A
D114-015	1½	1/4
D114-020	2	5/32
D114-212	1½ x 1¼	1/4

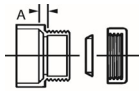

TRAP ADAPTER, FEMALE		
Part Number	Size	A
D104-012	1¼	1/8
D104-015	1½	1/8
D104-020	2	1/8
D104-212	1½ x 1¼	7/32

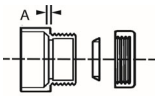

TRAP ADAPTER, FEMALE		
Part Number	Size	A
D116-015	1½	7/32
D116-020	2	5/32
D116-212	1½ x 1¼	7/32

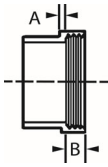

FITTING CLEANOUT ADAPTER			
Part Number	Size	A	B
D105-012	1¼	5/32	1/2
D105-015	1½	3/16	3/4
D105-020	2	3/16	3/4
D105-030	3	3/16	1 7/32
D105-040	4	9/32	1
D105-060	6	11/32	1 1/2

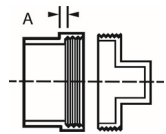

FITTING CLEANOUT ADAPTER + C.O. PLUG		
Part Number	Size	A
D112-012	1¼	5/32
D112-015	1½	3/16
D112-020	2	3/16
D112-030	3	3/16
D112-040	4	9/32
D112-060	6	5/16

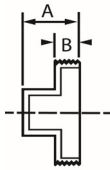

CLEANOUT PLUG, RAISED NUT			
Part Number	Size	A	B
D106-012	1½	1	17/32
D106-015	1½	1 3/8	5/8
D106-020	2	1 3/8	5/8
D106-030	3	1 23/32	3/4
D106-040	4	1 27/32	7/8
D106-060	6	2	1
D106-080	8	2 9/32	1 3/8

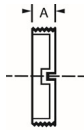

CLEANOUT PLUG, FLUSH			
Part Number	Size	A	Diameter
D110-020	2	11/16	2 3/16
D110-030	3	7/8	3 9/32
D110-040	4	29/32	4 5/16

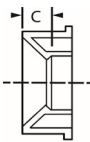

FLUSH BUSHING		
Part Number	Size	C
D107-212	1½ x 1¼	3/16
D107-250	2 x 1¼	13/32
D107-251	2 x 1½	13/32
D107-337	3 x 1½	1 1/16
D107-338	3 x 2	31/32
D107-420	4 x 2	1 9/32
D107-422	4 x 3	15/32
D107-532	6 x 4	1 3/4
D107-582	8 x 4	3 1/4
D107-585	8 x 6	1 11/16
D107-623*	10 x 3	4 3/8
D107-624*	10 x 4	4
D107-626	10 x 6	2 3/8
D107-628	10 x 8	1 13/32
D107-661*	12 x 3	5 13/16
D107-664*	12 x 4	5 5/8
D107-666*	12 x 6	4 1/8
D107-668	12 x 8	2 1/2
D107-670	12 x 10	1 7/16

*Assembled with two molded components

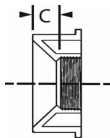

FLUSH BUSHING		
Part Number	Size	C
D108-251	2 x 1½	5/32

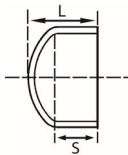

CAP			
Part Number	Size	L	S
447-015	1½	2	1 5/16
447-020	2	2 3/16	1 3/8
447-030	3	3 5/32	2 1/16
447-040	4	3 15/32	2 1/8
447-060	6	5 1/4	3 1/2
447-080	8	6 3/4	4 5/32
D116-100	10	8 1/4	5 1/4
D116-120	12	9 3/4	6 5/16

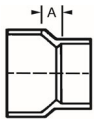

ADAPTER COUPLING

Part Number	Size	A
D117-040*	4	5/16
D117-422	4 x 3	3/4

*Assembled from two molded components

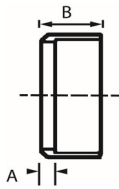

ADAPTER BUSHING

Part Number	Size	A	B
D118-030	3	7/32	1 23/32
D118-040	4	7/32	2

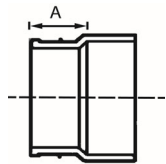

NO - HUB ADAPTER

Part Number	Size	A
D119-020	2	1 23/32
D119-030	3	2
D119-040	4	2

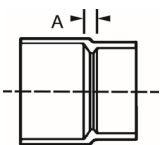

HUB ADAPTER, CAST IRON SOIL PIPE

Part Number	Size	A
D122-020	2	3/8
D122-030	3	3/8
D122-040	4	15/32

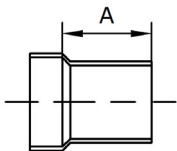

HUB ADAPTER, CAST IRON SOIL PIPE

Part Number	Size	A
D123-020	2	3 25/32
D123-030	3	4 5/32
D123-040	4	4 3/8

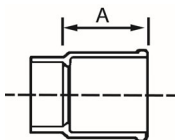

HUB ADAPTER, CAST IRON SOIL PIPE INCREASE

Part Number	Size	A
D123-251	2 x 1½	3 15/32
D123-341	3 x 4	4

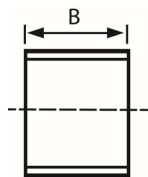

REPAIR COUPLING

Part Number	Size	B
D130-015	1½	1 21/32
D130-020	2	1 31/32
D130-030	3	3 1/4
D130-040	4	3 25/32

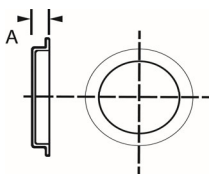

TEST CAP, INSERT TYPE

Part Number	Size	A
D131-015	1½	11/32
D131-020	2	11/32
D131-030	3	3/8
D131-040	4	7/16

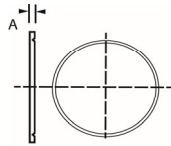

TEST CAP, PIPE		
Part Number	Size	A
D132-015	1½	3/32
D132-020	2	3/32
D132-030	3	1/16
D132-040	4	1/8

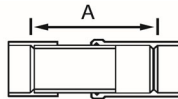

EXPANSION JOINT		
Part Number	Size	A
D133-015*	1½	5 19/32
D133-020*	2	6 1/4
D133-030*	3	7
D133-040*	4	8

Install in neutral position. Fitting has 1" inch travel in each direction

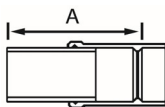

EXPANSION JOINT		
Part Number	Size	A
D134-015	1½	4 13/32
D134-020	2	5 1/8
D134-030	3	5 5/8
D134-040	4	6 13/16

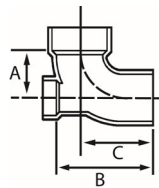

1/4 BEND, STREET w/LOW HEEL INLET				
Part Number	Size	A	B	C
D293-338	3 x 2	2 31/32	6 3/16	4 13/16

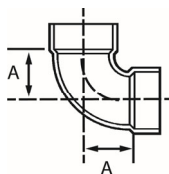

1/4 BEND		
Part Number	Size	A
D300-012	1¼	1 1/2
D300-015	1½	1 23/32
D300-020	2	2 5/16
D300-030	3	3 1/32
D300-040	4	4
D300-060	6	5 5/8
D300-080	8	6 1/16
D300-100	10	11
D300-120	12	12 7/32

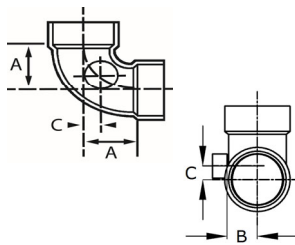

1/4 BEND, w/SIDE INLET				
Part Number	Size	A	B	C
D301-337	3 x 1½	3 1/32	1 21/32	1
D301-338	3 x 2	3 1/32	1 21/32	1

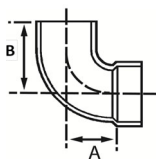

1/4 BEND, STREET				
Part Number	Size	A	B	
D302-012	1¼	1 19/32	2 1/4	
D302-015	1½	1 5/32	2 1/8	
D302-020	2	2 1/32	2 17/32	
D302-030	3	3 1/16	4 5/8	
D302-040	4	3 7/8	5 11/16	
D302-060	6	5 5/8	8 7/8	
D302-080	8	6 3/32	10 1/16	

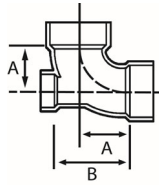

1/4 BEND, w/LOW HEEL INLET

Part Number	Size	A	B
D303-337*	3 x 1½	2 15/16	4 25/32
D303-338	3 x 2	2 15/16	4 1/2
D303-420	4 x 2	3 7/8	5 7/16

*Assembled from two molded components

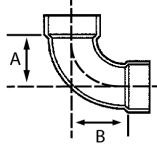

LONG SWEEP 1/4 BEND

Part Number	Size	A
D304-015	1½	2 11/16
D304-020	2	3 7/32
D304-030	3	4 3/32
D304-040	4	4 15/16
D304-060	6	7 8/89

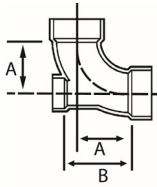

LONG SWEEP 1/4 BEND w/LOW HEEL INLET

Part Number	Size	A	B
D307-338	3 x 2	4	4 15/16

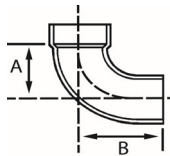

LONG SWEEP 1/4 BEND, STREET

Part Number	Size	A	B
D309-015	1½	2 3/4	3 7/16
D309-020	2	3 1/4	4 1/8
D309-030	3	4	5 19/32
D309-040	4	5	6 23/32

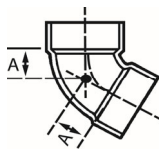

1/6 BEND

Part Number	Size	A
D319-015	1½	15/16
D319-020	2	1 11/32
D319-030	3	1 21/32
D319-040	4	2 1/8

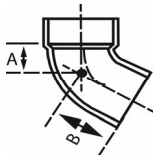

1/6 BEND, STREET

Part Number	Size	A	B
D320-015	1½	1	1 23/32
D320-020	2	1 5/16	2 3/16
D320-030	3	1 11/16	3 3/16
D320-040	4	2 1/16	3 13/16

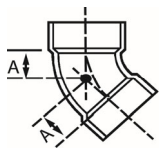

1/8 BEND

Part Number	Size	A
D321-015	1½	1 1/8
D321-020	2	1 1/2
D321-030	3	1 23/32
D321-040	4	2 7/32
D321-060	6	2 1/16
D321-080	8	2 1/16
D321-100	10	3 1/8
D321-120	12	3 1/2

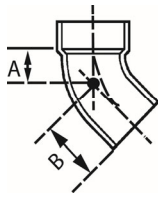

1/8 BEND, STREET

Part Number	Size	A	B
D323-015	1½	1 1/8	1 15/16
D323-020	2	1 1/2	2 3/8
D323-030	3	1 27/32	3 3/8
D323-040	4	2 3/16	3 15/16
D323-060	6	2	5 3/8
D323-080	8	2 1/16	6 9/32
D323-100	10	3 3/32	8 3/32
D323-120	12	3 15/32	9 17/32

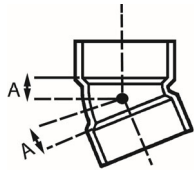

1/16 BEND

Part Number	Size	A
D324-015	1½	9/16
D324-020	2	11/16
D324-030	3	29/32
D324-040	4	1
D324-060	6	1 17/32
D324-100	10	1 13/16
D324-120	12	1 25/32

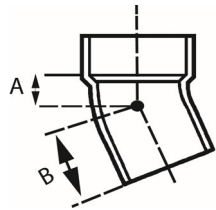

1/16 BEND, STREET

Part Number	Size	A	B
D326-015	1½	9/16	1 5/16
D326-020	2	11/16	1 7/16
D326-030	3	27/32	2 3/8
D326-040	4	1	2 3/4
D326-060	6	1 19/32	4 9/16

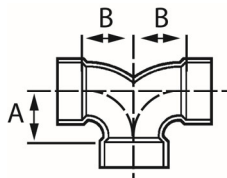

DOUBLE 1/4 BEND

Part Number	Size	A	B
D327-015	1½	1 23/32	1 11/16
D327-020	2	2 5/16	1 9/32
D327-030	3	3 3/32	3
D327-241	2 x 1½	1 15/16	2 3/32

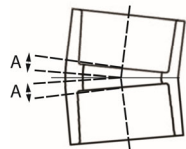

1/32 BEND

Part Number	Size	A
D328-100	10	1 1/32
D328-120	12	1 9/16

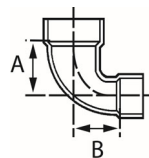

CLOSET BEND, REDUCING

Part Number	Size	A	B
D329-422	4 x 3	3 1/16	3 5/16

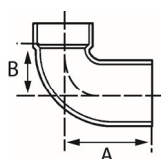

CLOSET BEND, REDUCING

Part Number	Size	A	B
D330-341	3 x 4	6 1/16	3 11/32

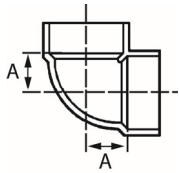

VENT ELL		
Part Number	Size	A
D331-015	1½	1 1/8
D331-020	2	1 15/32
D331-030	3	1 13/16
D331-040	4	2 5/16
D331-060	6	3 15/32
D331-080	8	4 1/2
D331-100	10	6 5/32
D331-120	12	7 3/16

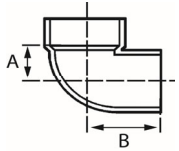

VENT ELL, STREET			
Part Number	Size	A	B
D333-015	1½	1 1/8	1 7/8
D333-020	2	1 15/32	2 3/8
D333-030	3	2 1/8	3 3/4
D333-040	4	2 21/32	5 1/16
D333-060	6	3 3/4	7
D333-080*	8	4 27/32	9 1/16
D333-100*	10	6 5/32	11 1/4
D333-120	12	7 1/16	13 11/32

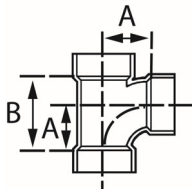

SANITARY TEE			
Part Number	Size	A	B
D400-012	1¼	1 9/16	2 5/16
D400-015	1½	1 11/16	2 11/16
D400-020	2	2 9/32	3 3/4
D400-030	3	3 1/8	4 7/8
D400-040	4	3 29/32	6 5/32
D400-060	6	5 13/32	9
D400-080	8	6	10 1/2

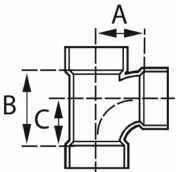

SANITARY TEE, REDUCING				
Part Number	Size	A	B	C
D401-241	2 x 1½ x 1½	2 5/32	3 5/32	1 29/32
D401-242	2 x 1½ x 2	2 9/32	3 23/32	2 11/32
D401-251	2 x 2 x 1½	2 5/32	3 1/8	1 15/16
D401-337	3 x 3 x 1½	2 1/2	2 21/32	1 23/32
D401-338	3 x 3 x 2	2 27/32	3 11/32	2 5/32
D401-420	4 x 4 x 2	3 1/4	3 7/32	2 1/8
D401-422	4 x 4 x 3	3 17/32	4 3/4	3 1/32
D401-532	6 x 6 x 4	4 3/4	6	3 11/16
D401-628*	10 x 10 x 8	6 11/32	10 3/8	5 3/16

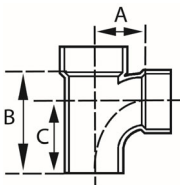

SANITARY TEE, STREET				
Part Number	Size	A	B	C
D403-015	1½	1 11/16	3 13/32	2 7/16
D403-020	2	2 11/32	4 7/16	2 5/16
D403-030	3	3 1/16	6 13/32	4 21/32
D403-040	4	3 13/16	8	5 27/32

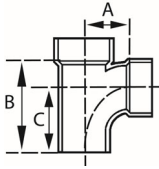

SANITARY TEE, STREET REDUCING

Part Number	Size	A	B	C
D404-241	2 x 1½ x 1½	2 1/8	4 5/32	2 27/32
D404-242	2 x 1½ x 2	2 11/32	4 1/2	3
D404-251	2 x 2 x 1½	2 1/8	4	2 27/32
D404-337	3 x 3 x 1½	2 1/2	4 1/8	3 9/32
D404-338	3 x 3 x 2	2 13/16	4 7/8	3 11/16
D404-420	4 x 4 x 2	3 9/32	4 29/32	3 25/32

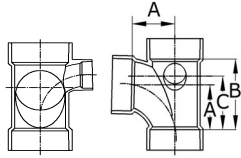

SANITARY TEE w/LEFT SIDE INLET

Part Number	Size	A	B	C
D416-337*	3 x 1½	3 1/16	4 27/32	3 11/16
D416-338	3 x 2	3 1/16	4 27/32	3 11/16
D416-420	4 x 2	3 29/32	6 1/8	5

*Assembled from two molded parts

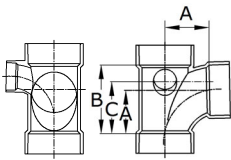

SANITARY TEE w/RIGHT SIDE INLET

Part Number	Size	A	B	C
D417-337*	3 x 1½	3	4 27/32	3 21/32
D417-338	3 x 2	3	4 27/32	3 11/16
D417-420	4 x 2	3 7/8	6 1/8	5

*Assembled from two molded parts

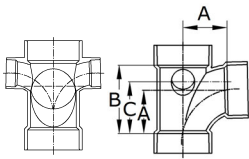

SANITARY TEE w/R & L SIDE INLET

Part Number	Size	A	B	C
D418-337	3 x 1½	3	4 25/32	3 23/32
D418-338	3 x 2	3	4 27/32	3 11/16
D418-420	4 x 2	3 7/8	6 1/8	5

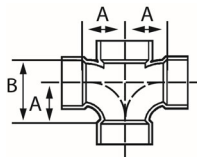

DOUBLE SANITARY TEE

Part Number	Size	A	B
D428-015	1½	1 3/4	2 3/4
D428-020	2	2 5/16	3 5/8
D428-030	3	3 3/32	4 7/8
D428-040	4	3 7/8	6 1/8

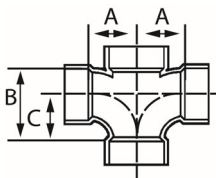

DOUBLE SANITARY TEE, REDUCING

Part Number	Size	A	B	C
D429-252	2 x 1½	2 1/8	3 5/32	2
D429-337	3 x 1½	2 1/2	2 25/32	2
D429-338	3 x 2	2 27/32	3 9/32	2 3/16
D429-420	4 x 2	3 7/32	3 1/8	2
D429-422	4 x 3	3	4 21/32	3

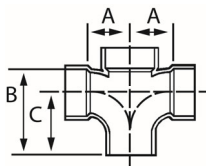

DOUBLE SANITARY TEE, STREET

Part Number	Size	A	B	C
D431-030	3	3 1/16	6 3/8	4 9/16
D431-251	2 x 1½	2 7/32	3 31/32	2 25/32
D431-338	3 x 3 x 2 x 2	2 25/32	4 11/16	3 19/32

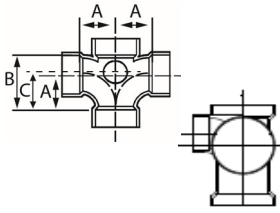

DOUBLE SANITARY TEE, w/SIDE INLET

Part Number	Size	A	B	C
D438-337	3x1½	3 3/32	4 27/32	3 21/32
D438-338	3 x 2	3 3/32	4 27/32	3 11/16
D438-420	4 x 2	3 7/8	6 3/32	4 31/32

*Assembled from two molded parts

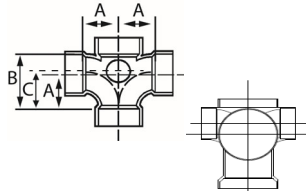

DOUBLE SANITARY TEE, w/R & L SIDE INLET

Part Number	Size	A	B	C
D439-337*	3x1½	3 1/32	3 29/32	3 11/16
D439-338	3 x 2	3 1/16	4 27/32	3 11/16
D439-420	4 x 2	3 7/8	6 1/16	5

*Assembled from two molded parts

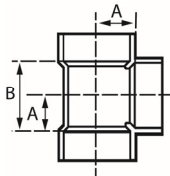

VENT TEE

Part Number	Size	A	B
D441-015	1½	1 5/32	2 5/16
D441-020	2	1 15/32	3
D441-030	3	1 27/32	3 11/16
D441-040	4	2 9/16	5 3/16
D441-060	6	4	8
D441-080	8	4 1/2	9 1/16
D441-100	10	5 7/8	11 3/4
D441-120	12	7	14

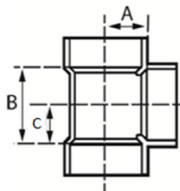

REDUCING VENT TEE

Part Number	Size	A	B	C
D441-624	10 x 10 x 4	5 31/32	10 7/8	5 7/16
D441-626	10 x 10 x 6	5 25/32	11	5 1/2
D441-628	10 x 10 x 8	5 15/16	10 7/8	5 15/32
D441-664	12 x 12 x 4	6 27/32	10 29/32	5 1/2
D441-666	12 x 12 x 6	6 27/32	10 29/32	5 1/2
D441-668	12 x 12 x 8	6 29/32	10 27/32	5 13/32
D441-670*	12 x 12 x 10	8 1/2	14 1/16	7

*Fabricated

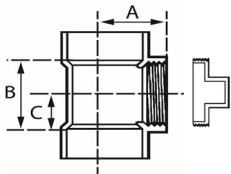

CLEANOUT TEE + C.O. PLUG

Part Number	Size	A	B	C
D443-015	1½	1 29/32	2 3/8	1 5/32
D443-020	2	2 7/32	3	1 15/32
D443-030	3	2 7/8	3 25/32	1 7/8
D443-040	4	3 29/32	5	2 1/2
D443-060	6	5 3/8	8	3 15/16
D443-080	8	6 7/8	10 11/32	5 3/16
D443-628	10 x 8	5 3/16	10 11/32	6 9/32
D443-668	12 x 8	6 15/16	10 7/32	5 5/32

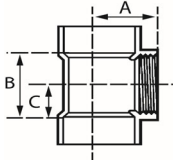

CLEANOUT TEE

Part Number	Size	A	B	C
D445-015	1½	1 29/32	2 3/8	1 5/32
D445-020	2	2 7/32	3	1 15/32
D445-030	3	2 21/32	3 25/32	1 7/8
D445-040	4	3 1/2	5	2 1/2
D445-060	6	5 11/32	8	3 15/16
D445-080	8	6 27/32	10 1/2	5 3/16
D445-628	10 x 8	5 3/16	10 11/32	6 9/32
D445-668	12 x 8	6 15/16	10 7/32	5 5/32

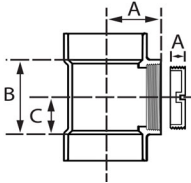

FLUSH CLEANOUT TEE (Test Tee)

Part Number	Size	A	B	C
D445-020X	2	2 7/32	3	1 15/32
D445-030X	3	2 7/8	3 25/32	1 7/8
D445-030X	4	3 29/32	5	2 1/2

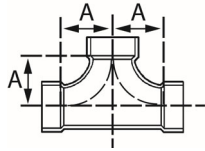

TWO-WAY CLEANOUT

Part Number	Size	A
D448-030	3	4
D448-040	4	4 15/16

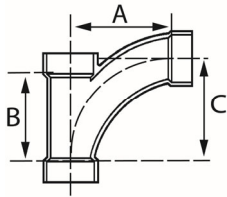

COMBINATION WYE + 1/8 BEND - LONG TURN

Part Number	Size	A	B	C
D501-015	1½	3 15/16	3 1/2	3 15/16
D501-020	2	5 1/8	4 7/16	5 1/8
D501-030	3	7 17/32	6 15/32	7 15/32
D501-040	4	10 1/16	8 1/2	10 1/32

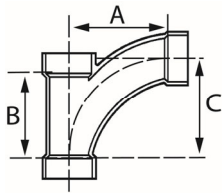

COMBINATION WYE + 1/8 BEND - LONG TURN, REDUCING

Part Number	Size	A	B	C
D502-241	2 x 1½	4 3/32	3 1/4	3 27/32
D502-251	2 x 1½	4 3/32	3 1/4	3 29/32
D502-337	3 x 1½	4 23/32	3 5/16	3 1/2
D502-338	3 x 2	5 11/16	4 7/16	5 1/8
D502-420	4 x 2	6 3/32	4 13/32	5 3/32
D502-422	4 x 3	7 7/8	6 5/16	7 15/32

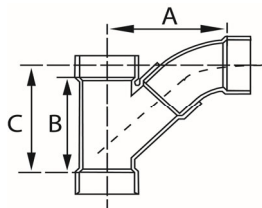

COMBINATION WYE + 1/8 BEND (Two Piece)

Part Number	Size	A	B	C
D503-015	1½	4 1/2	4	4
D503-020	2	5 13/16	5	5 11/16
D503-030	3	7 21/32	6 5/8	7 17/32
D503-040	4	9 15/32	8 1/4	9 5/32
D503-060	6	11 21/32	10 1/4	11 7/16
D503-080	8	15 1/32	14 1/8	15 13/32
D503-100	10	18 1/2	16 1/2	18 1/2
D503-120	12	21 17/32	19 15/32	21 17/32

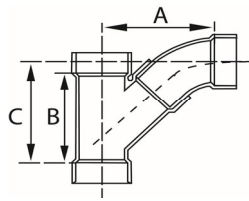

COMBINATION WYE + 1/8 BEND (Two Piece)

Part Number	Size	A	B	C
D504-338	3 x 2	6 9/32	5	5 23/32
D504-422	4 x 3	8 11/32	6 5/8	7 23/32
D504-532	6 x 4	10 11/32	6 29/32	8 11/32
D504-582	8 x 4	11 1/16	10 7/16	9 7/32
D504-585	8 x 6	12 15/32	10 7/16	11 1/2
D504-624	10 x 10 x 4	12 1/2	10 1/2	10 1/2
D504-626	10 x 10 x 6	13 23/32	10 15/16	11 15/16
D504-628	10 x 10 x 8	15 3/4	13 3/4	15 1/4
D504-664	12 x 12 x 4	13 15/32	10 15/16	12
D504-666	12 x 12 x 6	14 25/32	10 29/32	13 19/32
D504-668	12 x 12 x 8	16 3/16	16 15/16	16
D504-670	12 x 12 x 10	19 3/8	16 15/16	18 1/8

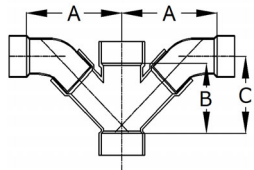

DOUBLE COMBINATION WYE + 1/8 BEND

Part Number	Size	A	B	C
D507-030	3	7 1/2	6 19/32	7 15/32
D507-040	4	9 17/32	8 7/32	9 1/4
D507-420	4 x 2	7	5 5/32	6 1/16
D507-422	4 x 3	8 9/32	6 19/32	7 21/32

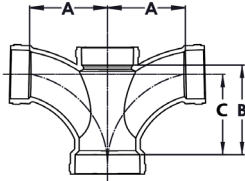

DOUBLE FIXTURE FITTING

Part Number	Size	A	B	C
D510-030	3	4 7/8	6 3/4	6 7/32
D510-241	2 x 1 1/2	2 7/8	3 15/32	3 3/16
D510-329	3 x 2 x 3 x 3	4 7/8	6 11/16	6 3/16

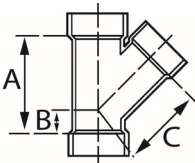

WYE

Part Number	Size	A	B	C
D600-015	1 1/2	3 29/32	1 1/8	2 7/8
D600-020	2	4 29/32	1 3/8	3 5/8
D600-030	3	6 5/8	1 5/8	5
D600-040	4	8 9/32	1 7/8	6 3/8
D600-060	6	10 3/16	1 3/4	8 7/16
D600-080	8	14 1/8	2 13/32	11 11/16
D600-100	10	16 1/2	2 27/32	13 21/32
D600-120	12	19 15/32	3 7/16	16 1/16

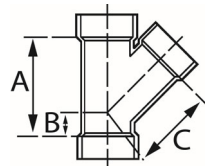

WYE, REDUCING

Part Number	Size	A	B	C
D601-241	2 x 1 1/2 x 1 1/2	3 7/8	1	3
D601-251	2 x 2 x 1 1/2	4 3/8	1 1/32	3 7/16
D601-337	3 x 3 x 1 1/2	4 1/4	1/2	4 11/32
D601-338	3 x 3 x 2	5	7/8	4 5/8
D601-420	4 x 4 x 2	5	3/8	5 9/16
D601-422	4 x 4 x 3	6 5/8	1 1/16	6
D601-530	6 x 6 x 3	7 5/32	7/32	7 1/2
D601-532	6 x 6 x 4	6 15/16	1/4	7 7/16
D601-582	8 x 8 x 4	10 7/16	11/32	8 9/16
D601-585	8 x 8 x 6	10 7/16	15/16	9 3/4
D601-624	10 x 10 x 4	10 31/32	1/4	10 7/16
D601-626	10 x 10 x 6	10 15/16	1/4	11 17/32
D601-628	10 x 10 x 8	13 13/16	1 1/4	13 3/32
D601-664	12 x 12 x 4	10 15/16	3/4	11 7/8
D601-666	12 x 12 x 6	10 29/32	3/4	13
D601-668	12 x 12 x 8	16 15/16	1 27/32	13 7/8
D601-670	12 x 12 x 10	16 15/16	1 13/16	14 15/16

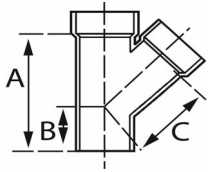

WYE, STREET

Part Number	Size	A	B	C
D602-015	1½	4 27/32	2	2 7/8
D602-020	2	6	2 11/32	3 5/8
D602-030	3	6 9/16	3	5
D602-040	4	8 5/32	3 17/32	6 3/8

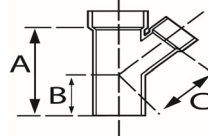

WYE, STREET, REDUCING

Part Number	Size	A	B	C
D603-337	3 x 3 x 1½	5 3/8	1 3/4	4 9/32
D603-338	3 x 3 x 2	6 11/16	2 9/16	4 5/8
D603-420	4 x 4 x 2	6 13/16	2 1/8	5 9/16
D603-422	4 x 4 x 3	8 13/32	2 27/32	6

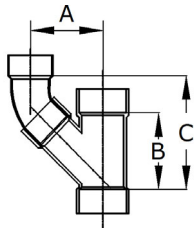

UPRIGHT COMBINATION WYE & 1/8 BEND (Two PC)

Part Number	Size	A	B	C
D605-020	2	4 9/32	4 29/32	7 1/8
D605-030	3	5 27/32	6 5/8	9 1/8
D605-100	10	15 13/32	16 1/2	21 5/16
D605-120	12	18 3/32	19 15/32	25

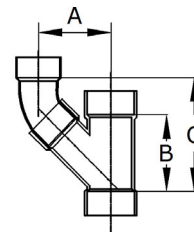

LARGE DIAMETER REDUCING UPRIGHT COMBINATION WYE & 1/8 BEND (Two PC)

Part Number	Size	A	B	C
D605-624	10 x 10 x 4	10 7/32	10 31/32	12 5/8
D605-626	10 x 10 x 6	11 23/32	10 15/16	13 15/16
D605-628	10 x 10 x 8	13 9/16	13 15/16	16 7/8
D605-664	12 x 12 x 4	11 1/4	10 15/16	14 7/32
D605-666	12 x 12 x 6	12 25/32	10 29/32	15 19/32
D605-668	12 x 12 x 8	14 1/8	10 15/16	18
D605-670	12 x 12 x 10	16 9/32	16 15/16	21 7/32

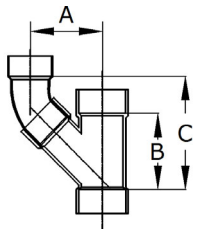

REDUCING UPRIGHT COMBINATION WYE & 1/8 BEND (Two PC)

Part Number	Size	A	B	C
D606-251	2 x 2 x 1½	3 23/32	4 11/32	5 13/16
D606-338	3 x 2	4 27/32	5	7 5/32

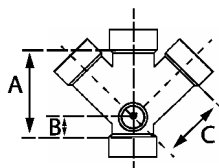

DOUBLE COTTAGE WYE w/2" INLET

Part Number	Size	A	B	C
D610-030	3	6 5/8	1 21/32	5
D610-040	4	8 1/4	1 7/8	6 3/8

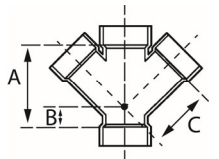

DOUBLE WYE

Part Number	Size	A	B	C
D611-015	1½	4	1 1/8	2 13/16
D611-020	2	4 15/16	1 3/8	3 19/32
D611-030	3	6 11/16	1 21/32	5
D611-040	4	8 1/4	1 7/8	6 13/32
D611-060	6	10 5/32	1 3/4	8 15/32

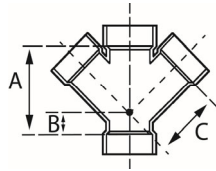

DOUBLE WYE, REDUCING

Part Number	Size	A	B	C
D612-252	2x1½	4 19/32	1 1/8	3 7/16
D612-337	3 x 1½	4 3/16	1/2	4 9/32
D612-338	3 x 2	5	7/8	4 5/8
D612-420	4 x 2	5 1/4	7/16	5 9/16
D612-422	4 x 3	6 5/8	1 3/32	5 29/32
D612-532	6 x 4	6 29/32	1/4	7 13/32

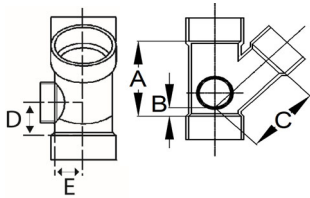

COTTAGE WYE, LH INLET

Part Number	Size	A	B	C	E
D625-030	3	6 5/8	1 19/32	4 15/16	1.75
D625-040	4	8 7/32	1 7/8	6 3/8	2.21875

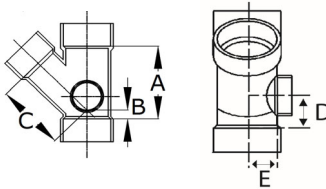

COTTAGE WYE, RH INLET

Part Number	Size	A	B	C	E
D626-030	3	6 5/8	1 19/32	4 15/16	1.75
D626-040	4	8 7/32	1 7/8	6 3/8	2.21875

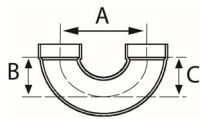

RETURN BEND

Part Number	Size	A	B	C
D700-015	1½	3 1/2	1 1/2	1 1/2
D700-020	2	5 7/32	2 11/32	2 11/32
D700-030	3	6 23/32	2 29/32	2 29/32
D700-040	4	8 17/32	3 5/8	3 5/8

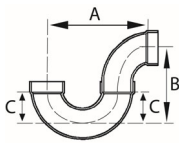

P-TRAP

Part Number	Size	A	B	C
D706-015	1½	4 7/8	3 29/32	1 1/2
D706-020	2	7 7/16	5 1/8	2 3/8
D706-030	3	8 7/8	6 21/32	2 29/32
D706-040	4	11 3/32	8 11/16	3 5/8

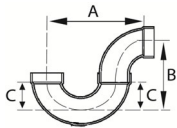

P-TRAP, LOW PROFILE

Part Number	Size	A	B	C
D706-016	1½	4 19/32	3 3/8	1 1/2
D706-021	2	6 11/16	4 1/2	2 3/8

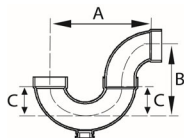

P-TRAP w/CLEANOUT

Part Number	Size	A	B	C
D707-015	1½	4 21/32	3 11/16	1 15/32
D707-020	2	7 3/16	4 5/8	2 11/32

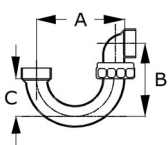

P-TRAP, UNION

Part Number	Size	A	B	C
D708-015	1½	4 7/8	3 7/8	1 15/32
D708-020	2	7 7/16	5 1/8	2 3/8

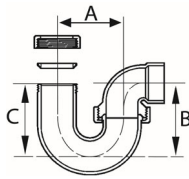

LA PATTERN P-TRAP

Part Number	Size	A	B	C
D711-015	1½	4 29/32	3 7/8	3 23/32
D711-212	1½ x 1¼	4 7/8	3 7/8	3 11/32

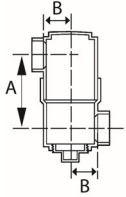

DRUM TRAP

Part Number	Size	A	B
D720-015	3 x 6 x 1½	4 19/32	1 23/32

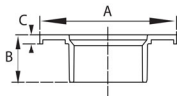

CLOSET FLANGE (One Piece)

Part Number	Size	A	B	C
D800-040	4	7	2 1/32	15/32
D800-422	4 x 3	7	2 15/32	7/16

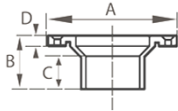

CLOSET FLANGE (One Piece)

Part Number	Size	A	B	C
D801-040	4	7	2 3/32	1 13/16
D801-422	4 x 3	7	2 3/4	1 9/16

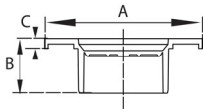

CLOSET FLANGE w/KNOCK OUT (One Piece)

Part Number	Size	A	B	C
D810-422	4 x 3	7	2 13/32	7/16

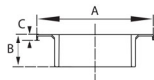

CLOSET FLANGE, ADJUSTABLE w/METAL RING

Part Number	Size	A	B	C
D811-040	4	7	2 1/32	11/32

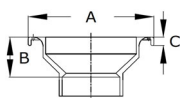

CLOSET FLANGE, ADJUSTABLE w/METAL RING

Part Number	Size	A	B	C
D811-422	4x3	7	1 1/4	5/16

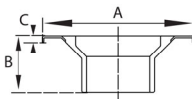

CLOSET FLANGE, ADJUSTABLE w/METAL RING

Part Number	Size	A	B	C
D812-040	4	7	2 7/8	5/16
D812-422	4x3	7	2 3/4	5/16

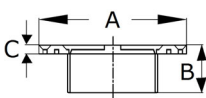

FLUSH CLOSET FLANGE w/KNOCK OUT

Part Number	Size	A	B	C
D815-422	4x3	7	2 13/32	7/16

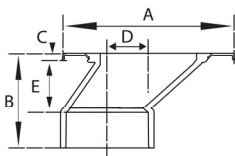

OFFSET CLOSET FLANGE

Part Number	Size	A	B	C	E	
D822-422	w/Plastic Ring	4x3	7	4 7/32	7/16	2.125

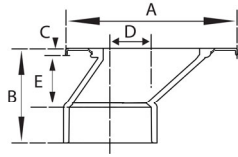

OFFSET CLOSET FLANGE

Part Number	Size	A	B	C	E
D823-422					
w/Metal Ring	4x3	7	4 4/21	22/71	2.375



CUSTOMER SERVICE
Phone: (800) 776-2756 | Fax: (731) 772-0835
Email: customerservice@lascofittings.com
www.lascofittings.com

LIMITED WARRANTY

LASCO Fittings, Inc. products are warranted to be free from manufacturing defects in materials and workmanship. They are warranted against rot, rust, and electrolytic corrosion for a period of three years from date of installation. If LASCO products prove defective due to manufacturing defects in material or workmanship during that period, the manufacturer will provide new replacement units of the same type and size. No remedy will be granted under this warranty if LASCO products are not used strictly in accordance with LASCO's directions with respect to use and storage or if the products have been modified in any way.

THE MANUFACTURER'S LIABILITY UNDER EXPRESSED OR IMPLIED WARRANTY OR FOR ANY REASON IS LIMITED TO FURNISHING REPLACEMENT UNITS OR GRANTING A CREDIT FOR DEFECTIVE UNITS. NO LABOR EXPENSE OR CONSEQUENTIAL DAMAGES WILL BE PAID BY LASCO. THIS WARRANTY IS IN LIEU OF ALL OTHER GUARANTEES AND WARRANTIES, EXPRESSED OR IMPLIED, INCLUDING BUT NOT LIMITED TO, WARRANTIES OF MERCHANTABILITY AND FITNESS FOR PURPOSE, EXCEPT FOR ANY WARRANTIES IMPLIED BY LAW FOR NONCOMMERCIAL CONSUMERS. ANY SUCH WARRANTIES ARE LIMITED TO THE DURATION OF THIS WRITTEN WARRANTY.

DO NOT USE LASCO FITTINGS FOR COMPRESSED AIR OR GASES.
DO NOT TEST PVC PIPING SYSTEMS WITH COMPRESSED AIR OR GASES.
DO NOT USE FITTINGS WITH LIQUIDS NOT RECOMMENDED BY LASCO.
MODIFICATIONS OF FITTINGS VOIDS THE WARRANTY.

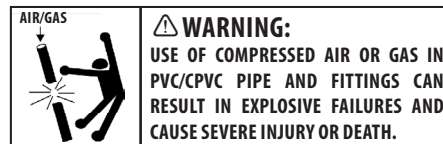

STANDARDS AND SPECIFICATIONS

- ASTM D-2665 – Poly (Vinyl Chloride) (PVC) Plastic Drain, Waste, and Vent Pipe and Fittings.
- ASTM D-1784 – Rigid Poly (Vinyl Chloride) (PVC) Compounds and Chlorinated Poly (Vinyl Chloride) (CPVC) Compounds.
- ASTM D-3311 – Drain, Waste, and Vent (DWV) Plastic Fittings Patterns
- MATERIAL – Lasco DWV Fittings are produced from PVC Type I, Cell Classification 12454-B. PVC Fittings are listed by NSF (National Sanitation Foundation). Product is certified to the Uniform Plumbing Code™.

Standard Terms and Conditions of Sale

1. Terms: 2% 35 days, net 45 days.
2. Freight: FOB LASCO warehouses. Prepaid on orders for products only totaling 1\$1650 net for one shipment to single destination within the contiguous United States.
3. Minimum Order: \$100 net. Smaller orders billed at this minimum charge.
4. Claims for shipping errors must be made within 15 days to LASCO. Claims for damage or shortages should be directed promptly to the common carrier by the consignee.
5. Returns will be accepted only by prior authorization and if shipped freight prepaid. Returned merchandise subject to a 25% handling/restocking charge.
6. Pricing is subject to change without prior notice. However, prior notification will be given in the event of price changes in the period between order placement and scheduled shipment.
7. Offer to sell is not implied by possession of this or other LASCO price lists.

